

Installation instructions for FK-5

Break Tank Station
Fig. 369 06





Safety instructions for installation, maintenance and operation

Installation and use

Prior to commencing installation or use, read instructions carefully and follow all directions! Pass these instructions on to the system operator and retain for later reference!

Warning! Installation and maintenance must only be performed by competent and qualified professionals with a qualification in sanitary plumbing.

Electrical installation must only be performed by professionals qualified for electrical facilities!

Warning! Local rules and regulations for sanitary plumbing as well as accident prevention must be observed as a matter of priority.

Warning! Ensure sufficient bracketing, bearing capacity and statics. Select bracketing components according to wall and ground properties.

Note! The installation location must be a closed-in, dry and frost-proof room, that cannot be flooded.

Upstream and downstream of the break tank station stop valves must be provided. The feed lines must be fitted with a dirt strainer each of mesh size ≤ 0.6 mm (e.g. KEMPER Fig. 602).

Note! It is essential to carry out a leak test of the water-bearing components as well as a functional test after installation.

Danger! To isolate from mains disconnect the mains plug prior commencing any maintenance work.



Note! The installation of the FK5 adjacent to living rooms, bedrooms, classrooms or work areas, is only to be installed to the floor. Use flexible hoses to connect the supply lines.

Warning information

Please read and follow the warning information in these instructions. Disregarding the warning information may lead to injury or material damage!

Labelling of important warning information:



Danger! Electricity!

Indicates hazards that may result in severe or fatal injury.



Warning! Indicates hazards that may lead to injury, material damage or contamination of drinking water.



Note! Indicates hazards that may lead to damage to the system or malfunctions.

Use

The KEMPER FK-5 Break Tank Station is used for separating potable from non-potable water installations of fluid category 5 according to DIN EN 1717 / DIN 1988-100.

The device must only be operated with water.

Do not fill with flammable or explosive media.

Warning! The product must only be used as a break tank station in closed-off, frost-protected, dry rooms. Any other use is considered misuse.

Warning! Disregarding the instructions during installation, use or maintenance can impair proper operation and can cause considerable health problems due to the mixing of drinking and non-potable water.



Note!

Service hotline for the areas of commissioning and maintenance

Tel.: +49 2761 891-888

E-mail: servicegt@kemper-olpe.de

After-sales service

Service hotline

Tel.: +49 2761 891 800

E-mail: anwendungstechnik@kemper-olpe.de



Safety instructions for installation, maintenance and operation



Warning! Always connect an expansion vessel PN10 with min. 33 liter to the pressurized secondary outgoing pipe. The pre-charge pressure of the expansion vessel must always be 0.5 bar below the cut-in pressure of the FK-5

Power supply	230 V AC
Electrical power input	DN 20: 3.3 A DN 25: 5.5 A
Electrical power	DN 20: 759 W DN 25: 1265 W
Power factor	0,97
Protection class	IP 54
Medium	Water
Ambient temp., max.	40 °C
Ambient temp., min.	2 °C
Inflowing medium, temp. max.	35 °C
Inflowing medium, temp. min.	2 °C
Flow pressure, max.	DN 20/DN 25: 4 bar 0.4 MPa
Flow pressure, min	DN 20: 1 bar 0.1 MPa DN 25: 1.5 bar 0.15 MPa
Pressure stage	PN 10
Outlet pump pressure	DN 20: 4.3 bar 0.43 MPa DN 25: 5.9 bar 0.59 MPa
DU value	DN 20: 0.83 l/s DN 25: 1.67 l/s
Flush volume of PWC line (at 3 bar)	10 l/min



Warning! Under no circumstances must any water drawn be used as drinking water - even in small amounts!

Warning! Following the installation, addition of accessories or maintenance, all feed lines must be flushed according to DIN EN 806-5 and VDI/DVGW (Association of German Engineers/ German association for gas and water) 6023.

Liability

No warranty or liability will be accepted in case of:

- Non-compliance with the instructions.
- Incorrect installation and/or operation.
- Unauthorised modification of the product.
- Other incorrect operation.



Disposal

Local regulations on waste recycling and disposal must be followed.

The product must not be disposed of with household waste but must rather be disposed of in accordance with local regulations.

1. Only use the device
 - in sound condition
 - as intended
2. Parallel installation of two or more break tank stations is not permitted.
3. It is essential that the specified maintenance intervals are kept.

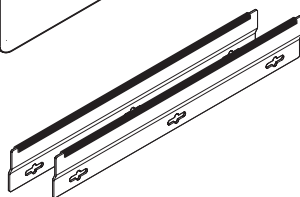
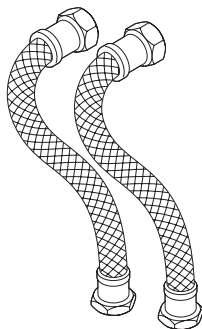
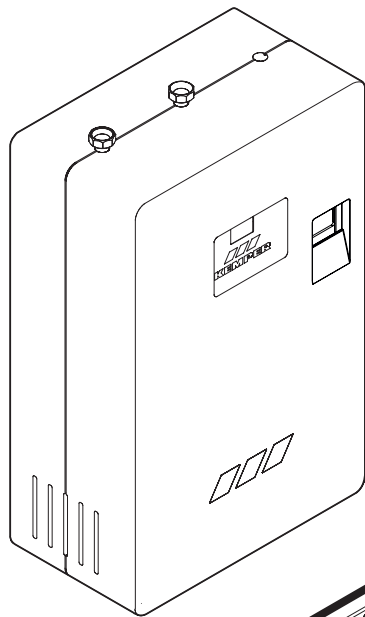

		Art.-No.
GB	Typ: G	DN 20 = 3690602000 DN 25 = 3690602500



**DIN EN 806-5
DIN EN 1986-100
DIN EN 12056**

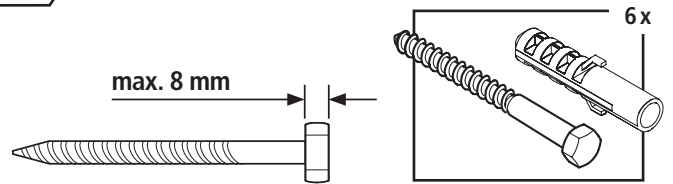
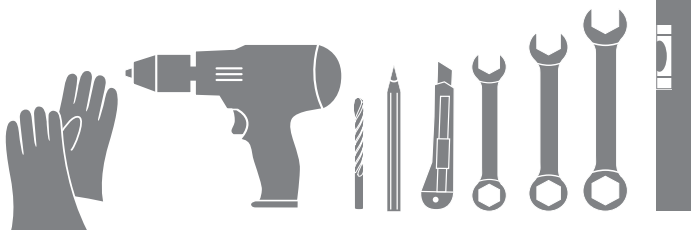

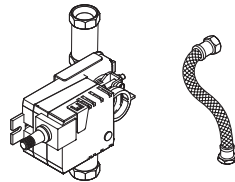
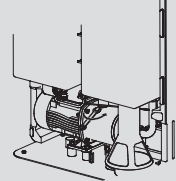
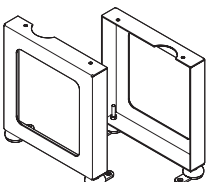
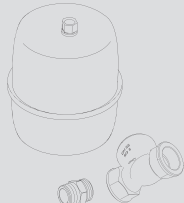
Pos.	Art.-No.
	DN 20 = 3692202000 DN 25 = 3692202500
	3690200100
	3690300100
	3692700100



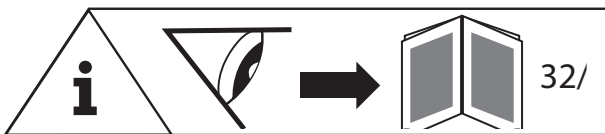
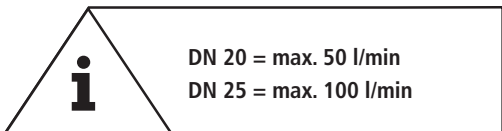
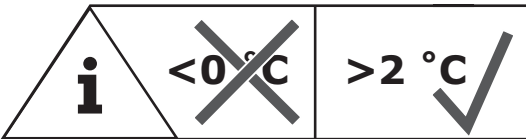
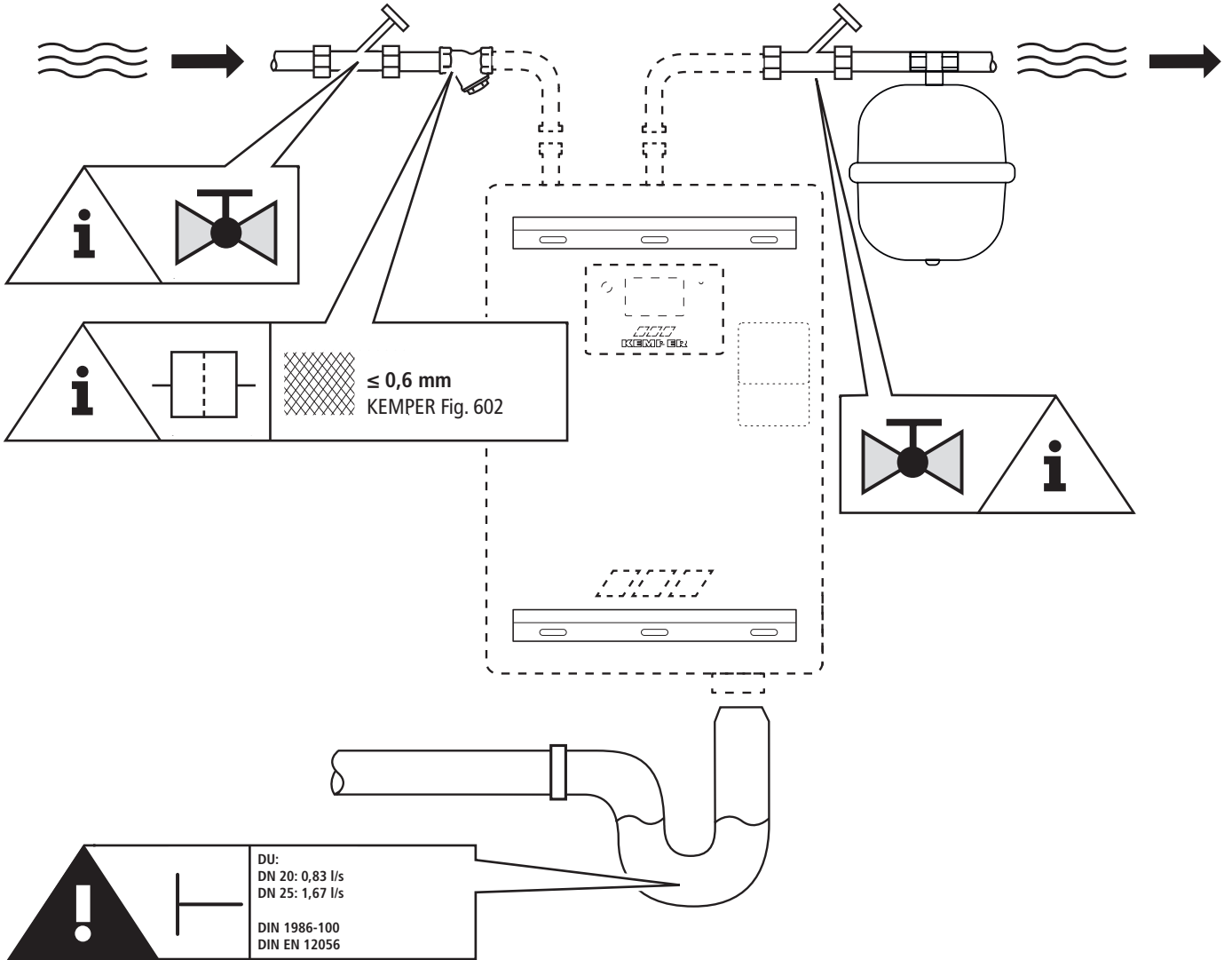

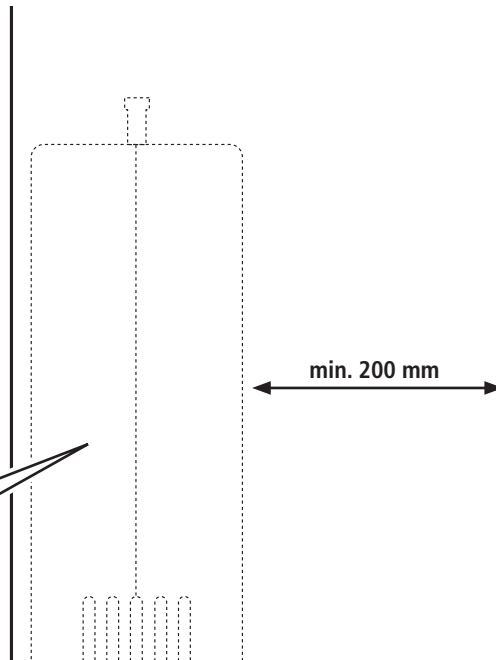
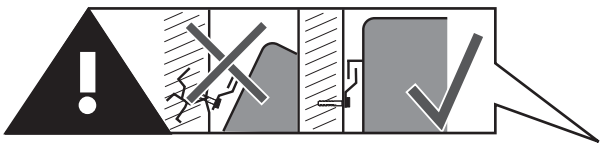
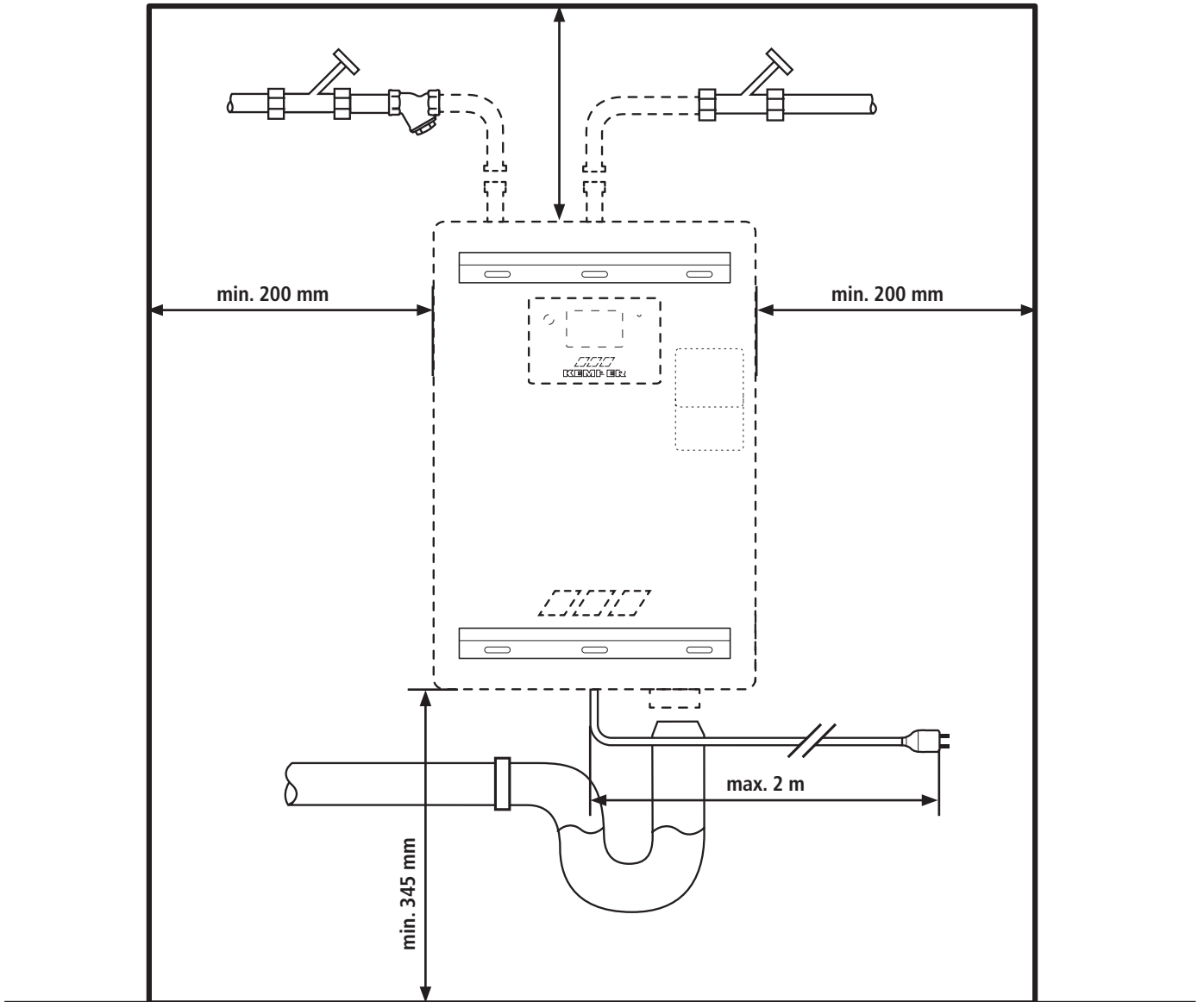
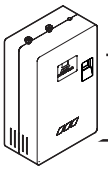



A

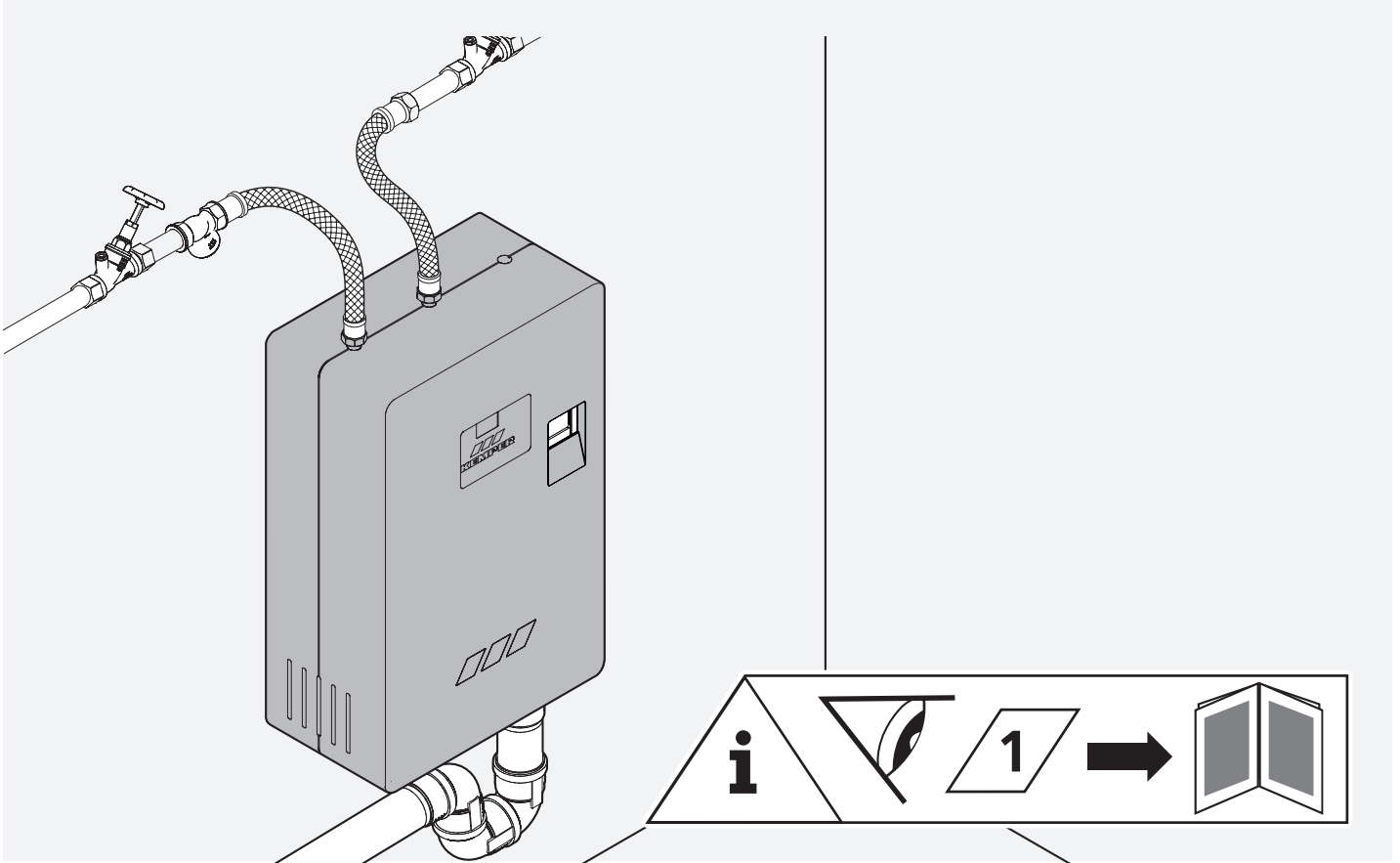

B

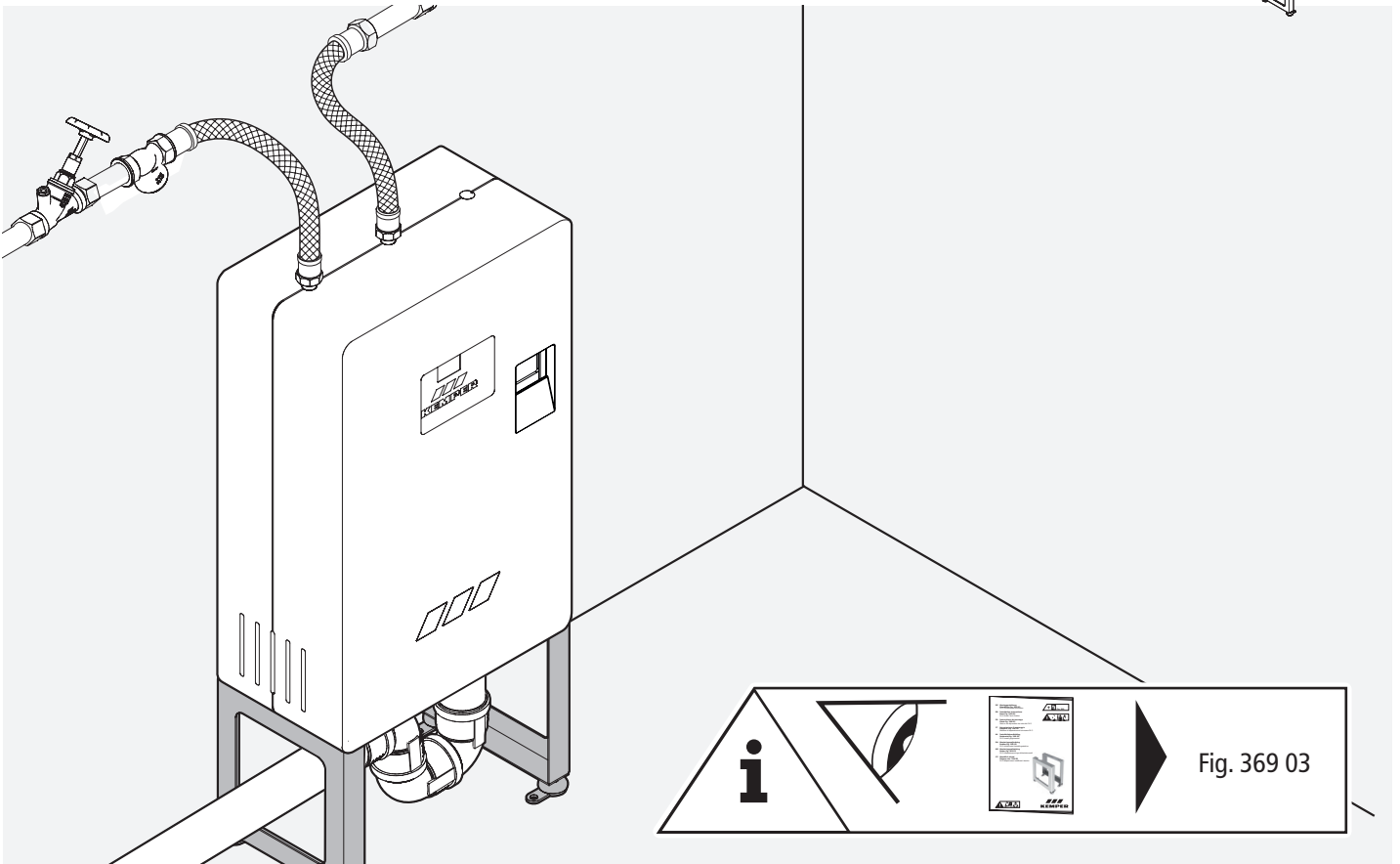

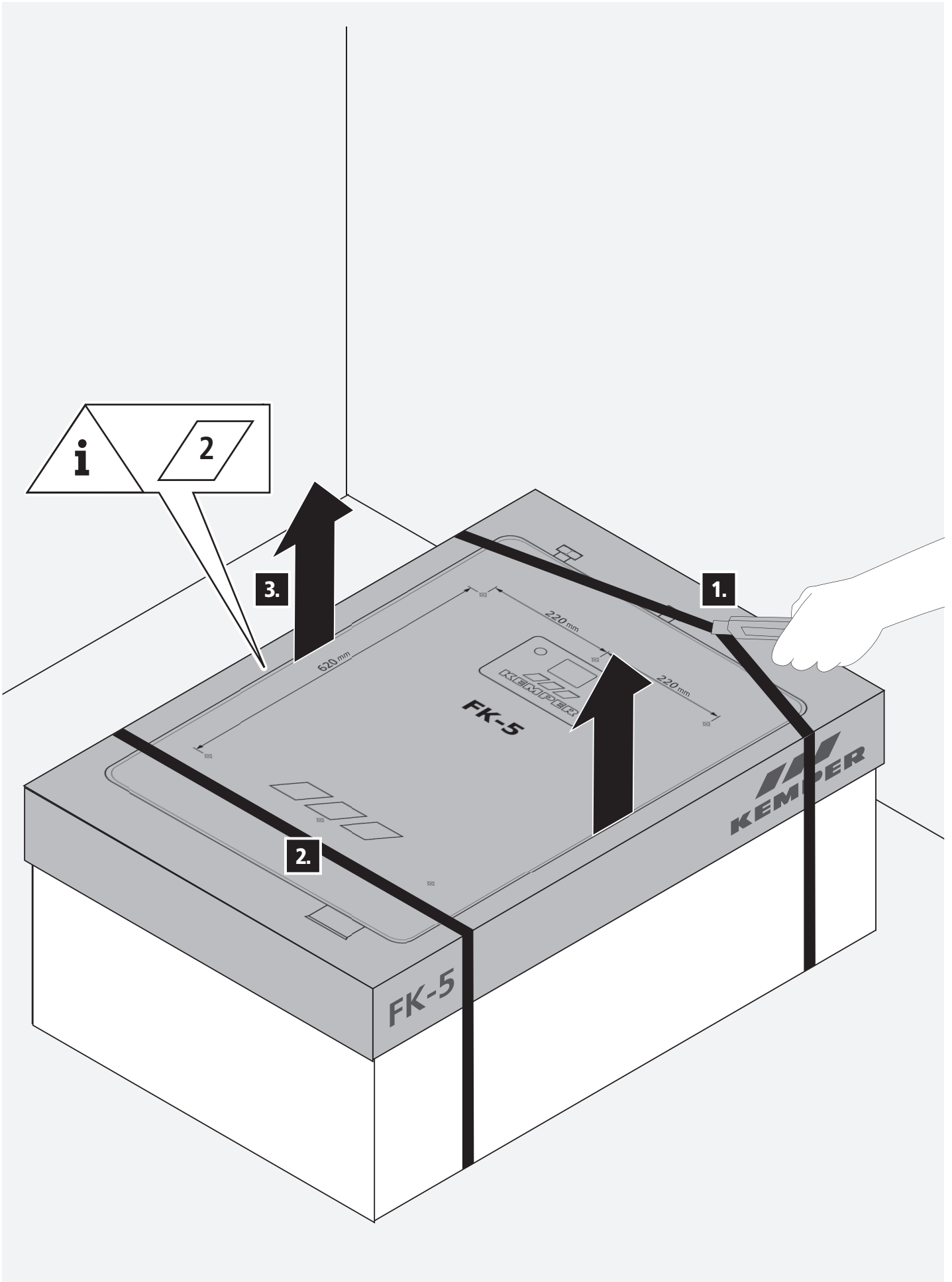
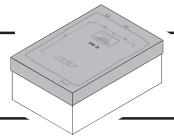

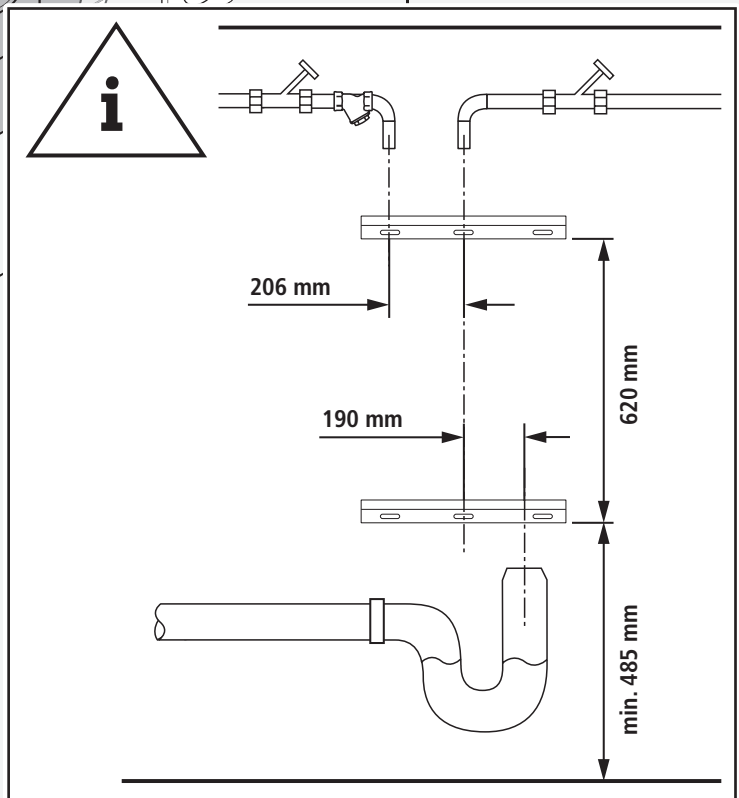
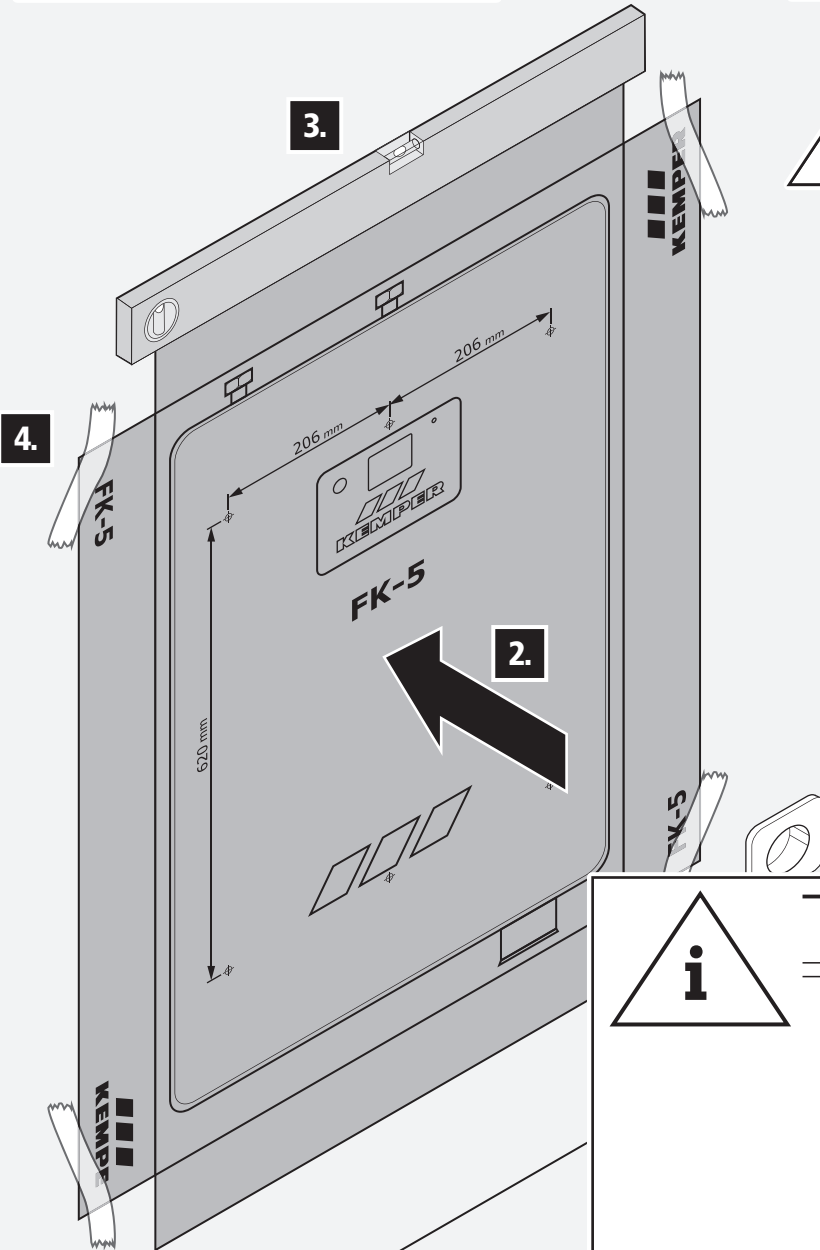
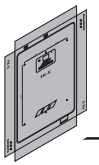

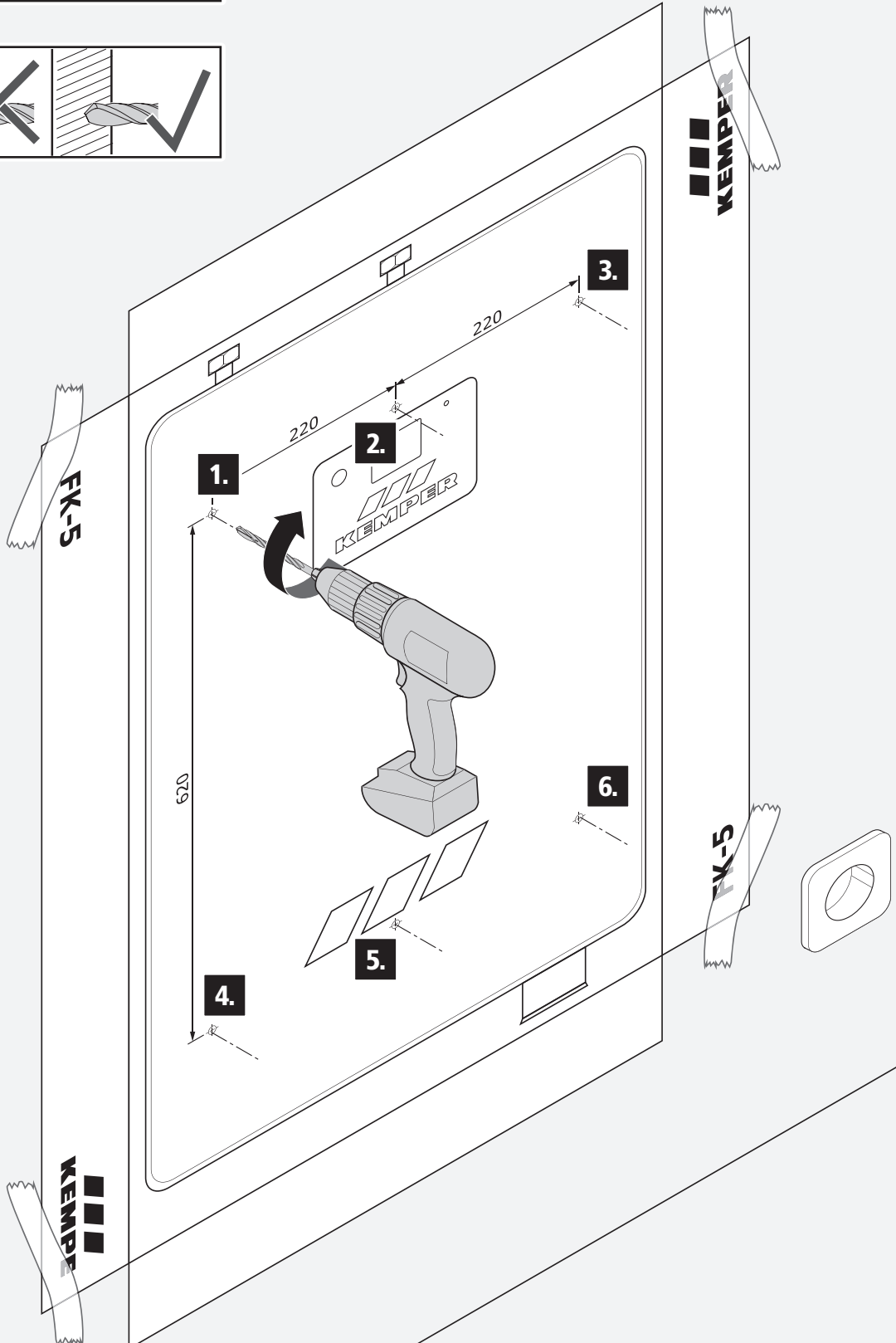
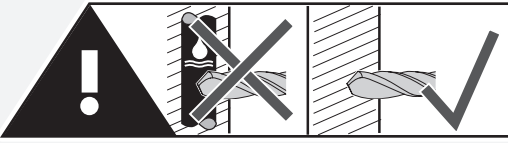

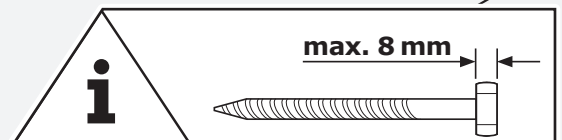
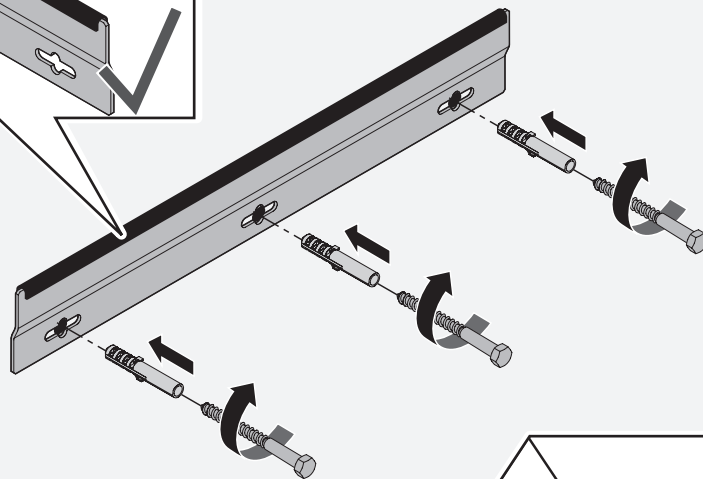
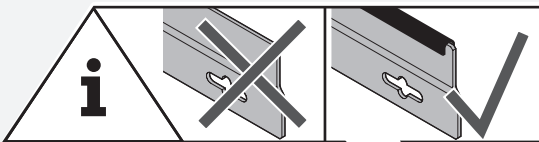
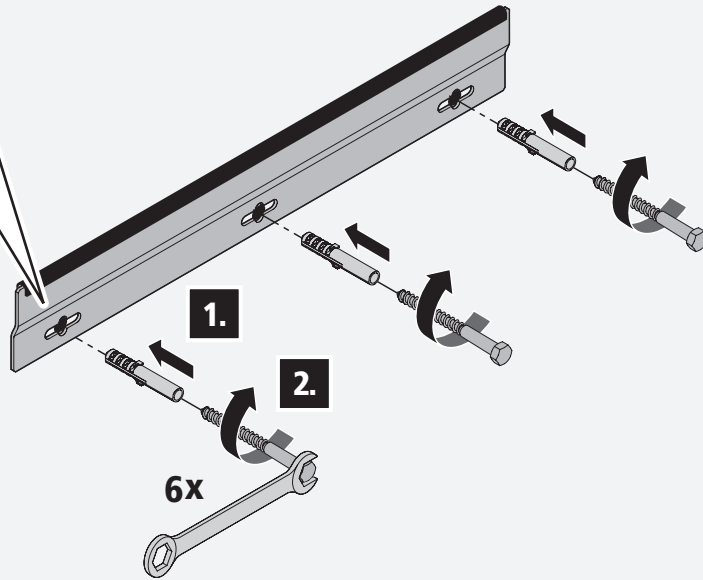
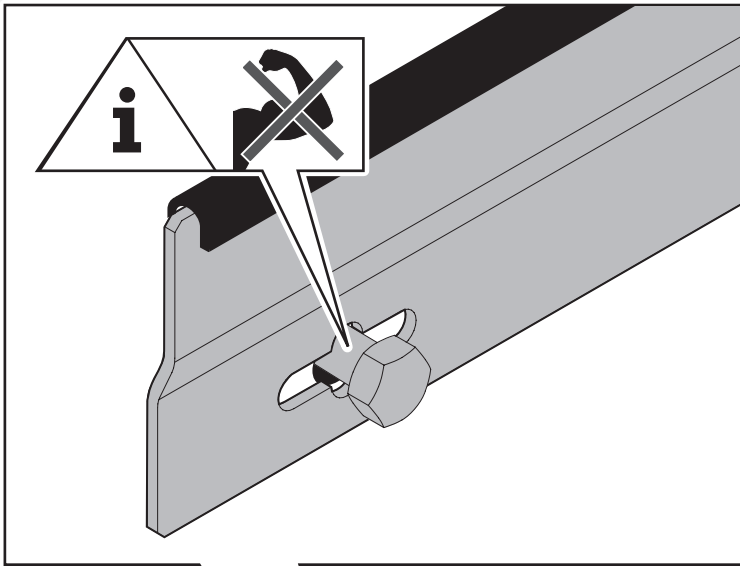

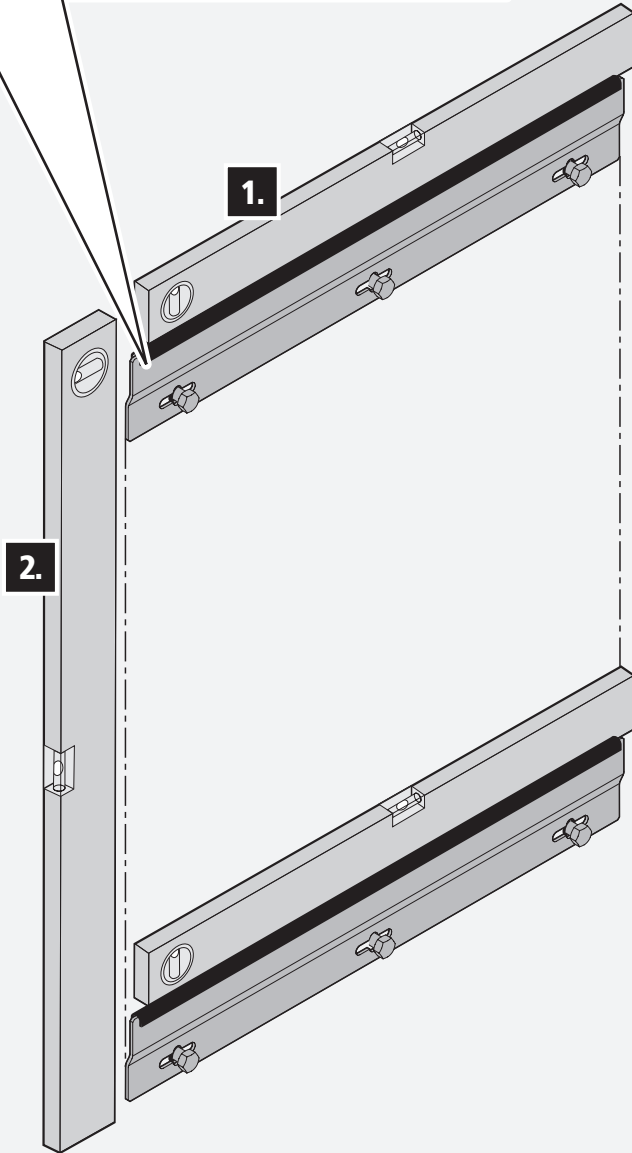
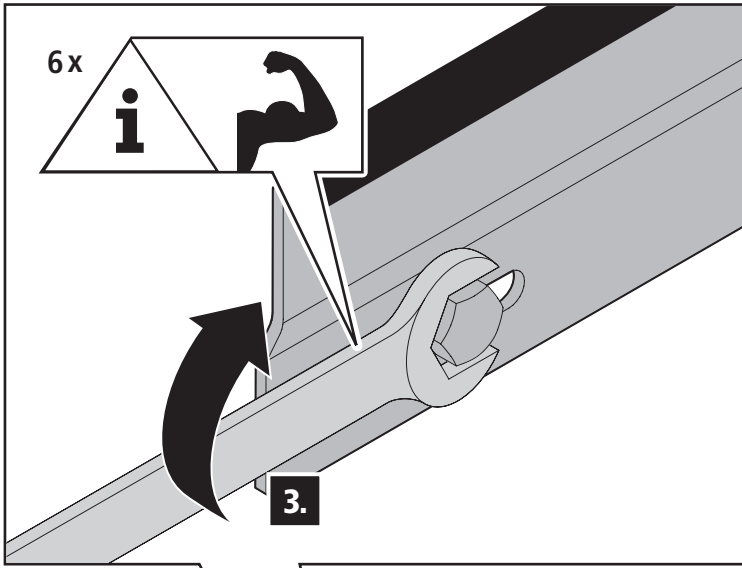
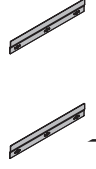

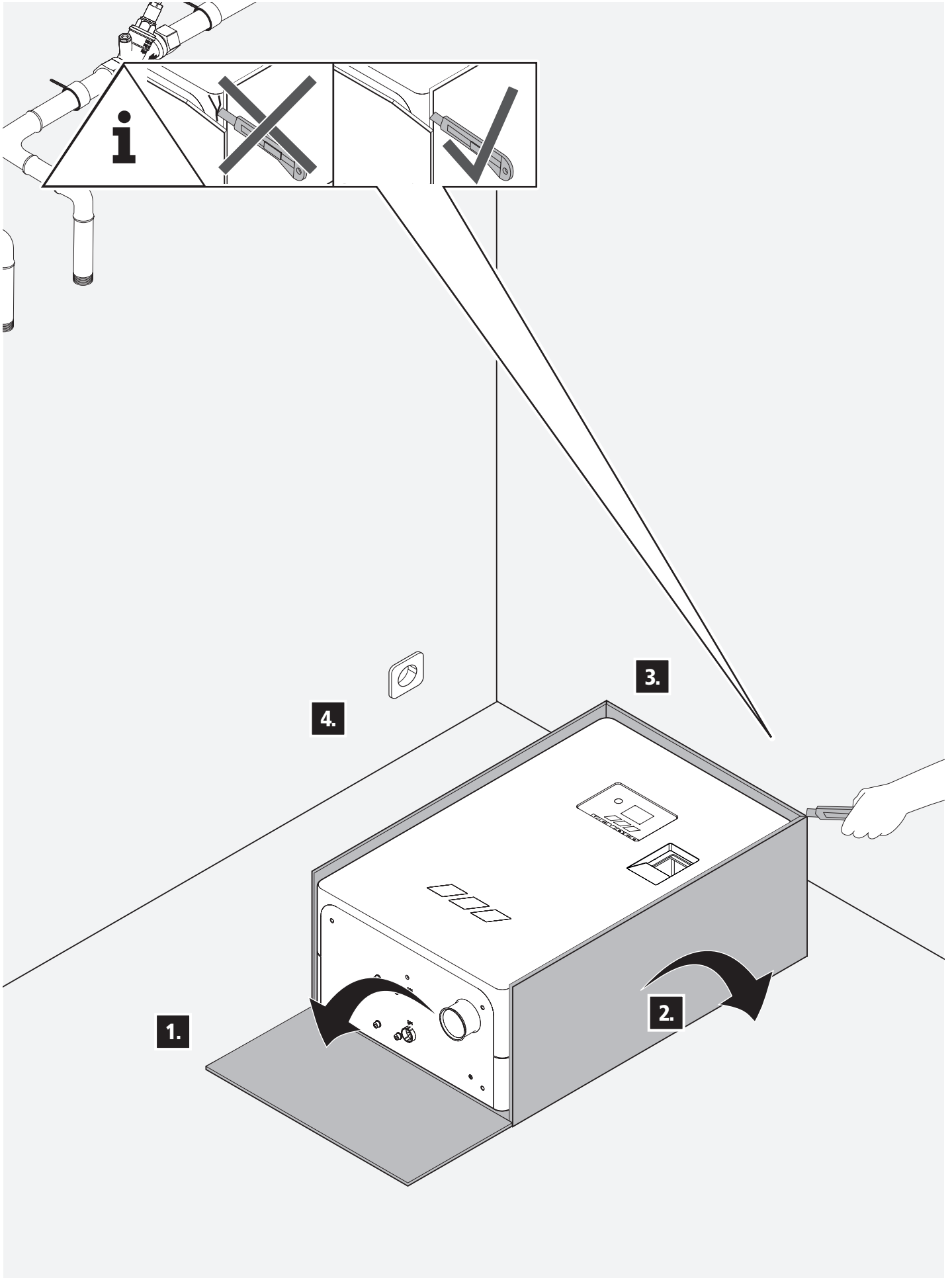
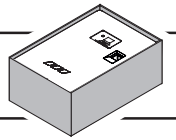

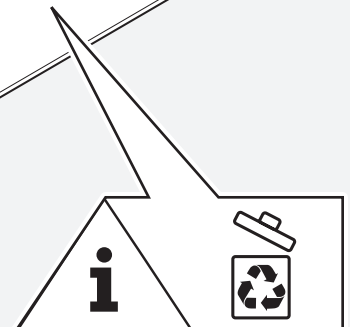
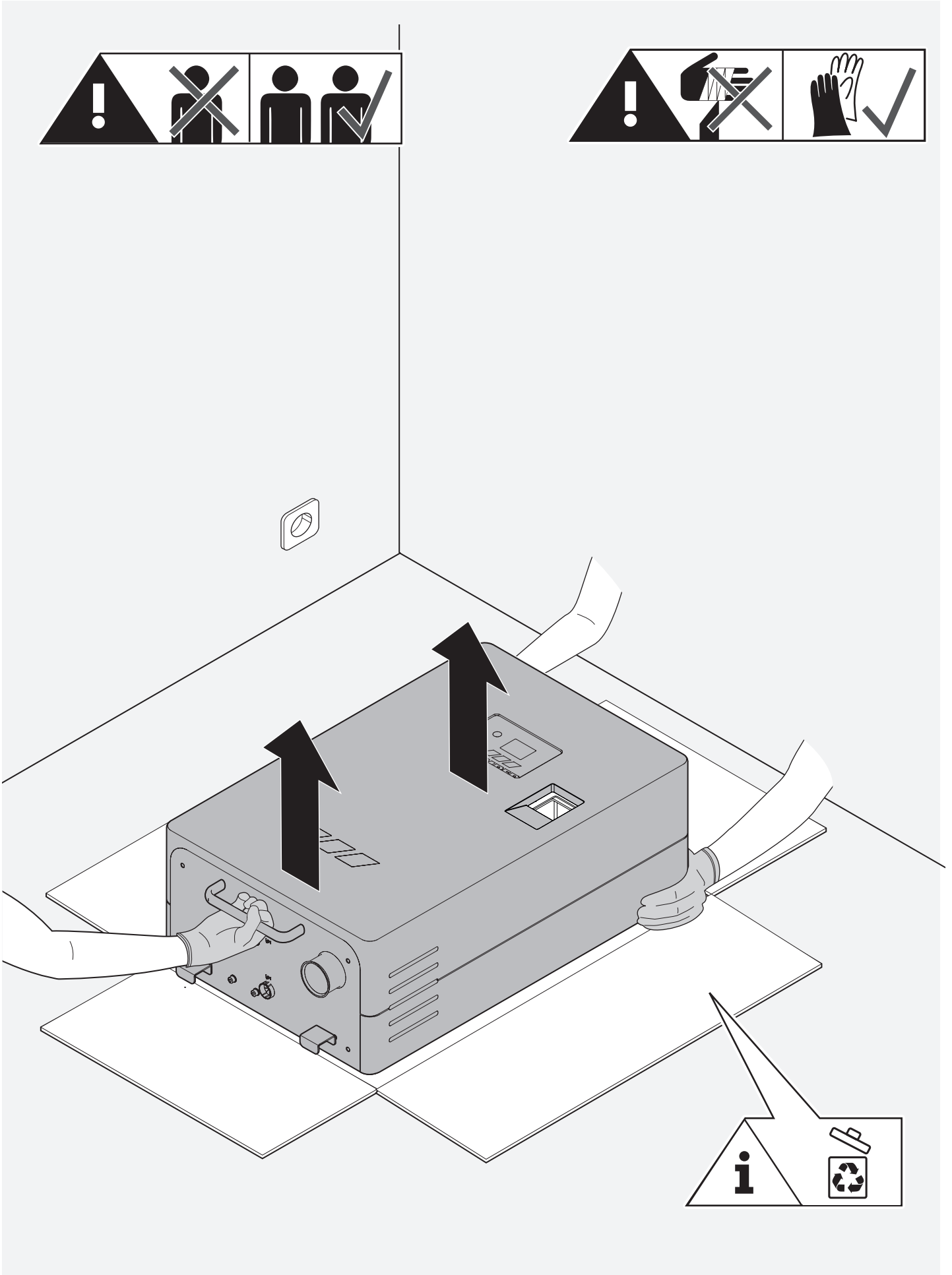
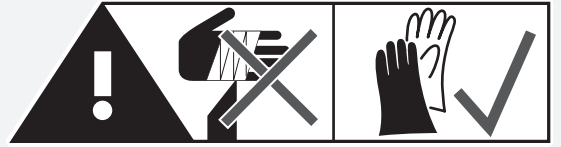

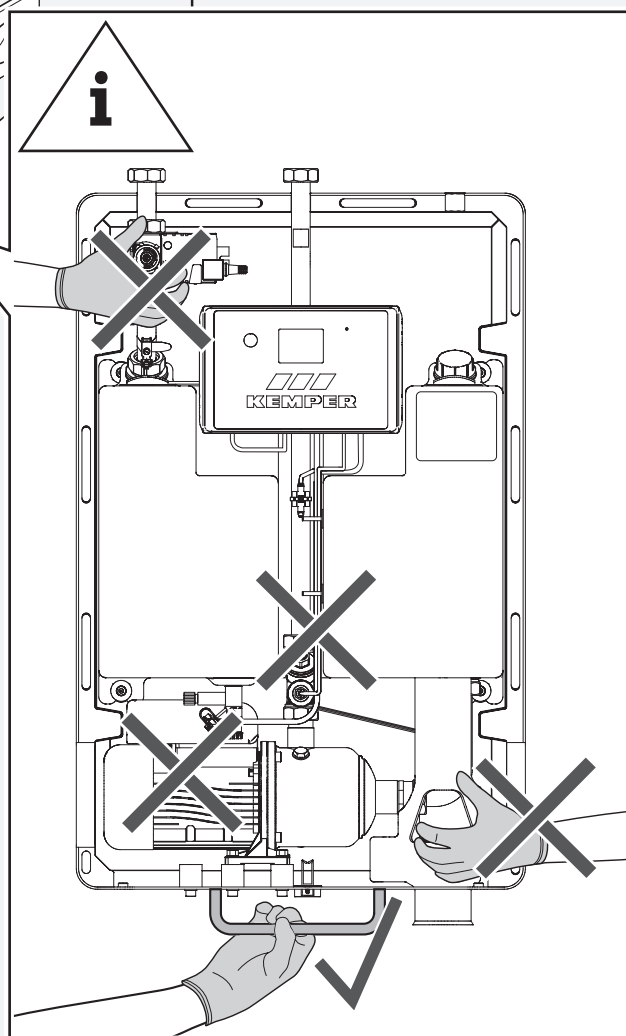
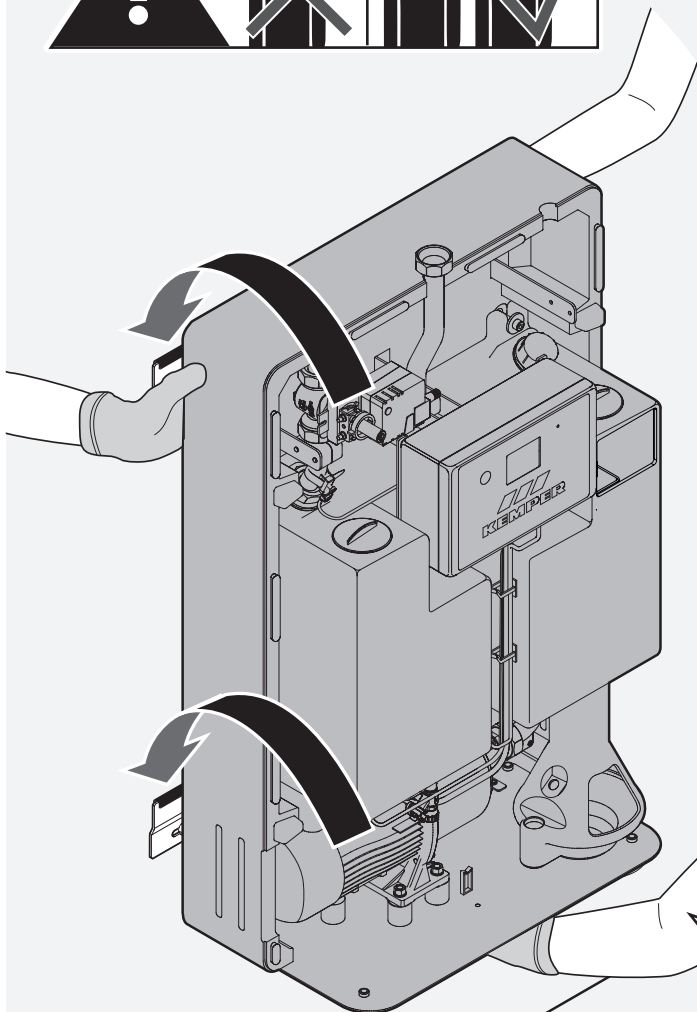
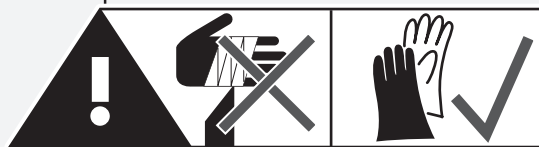
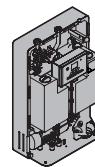

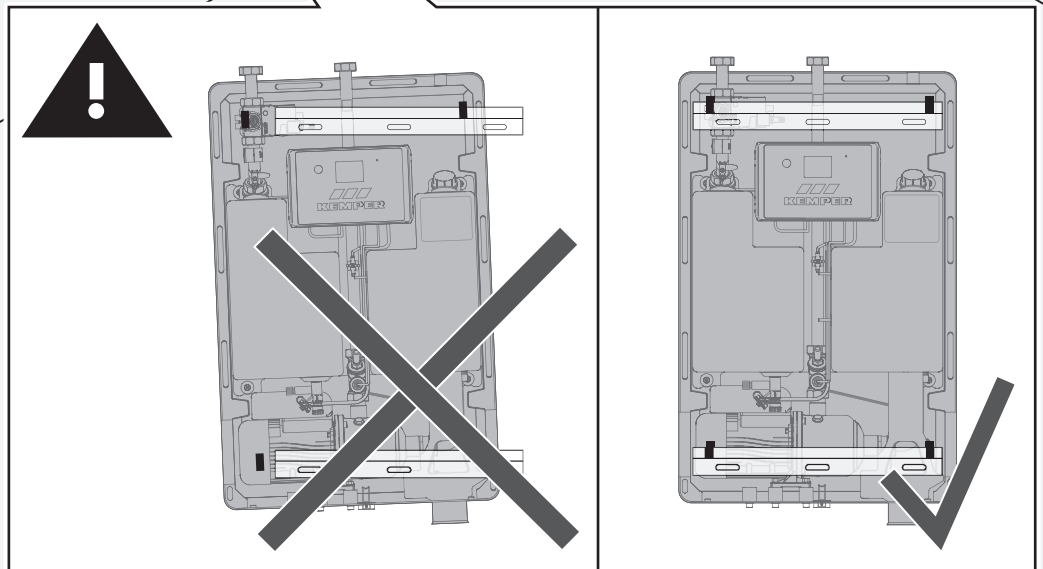
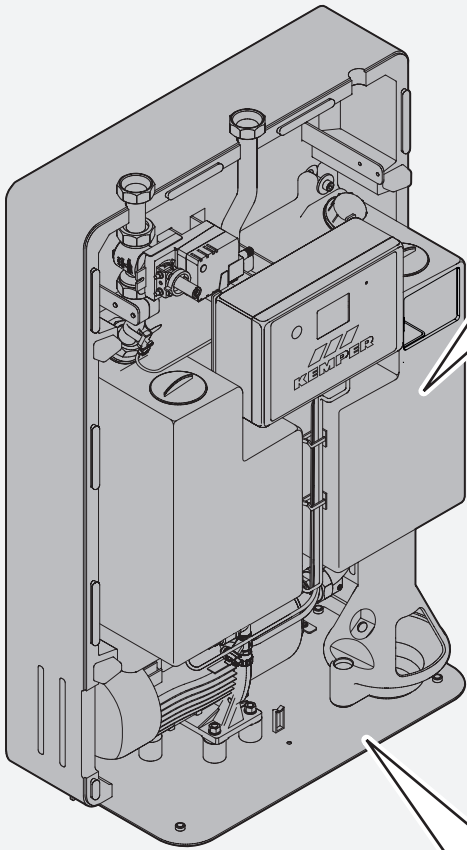
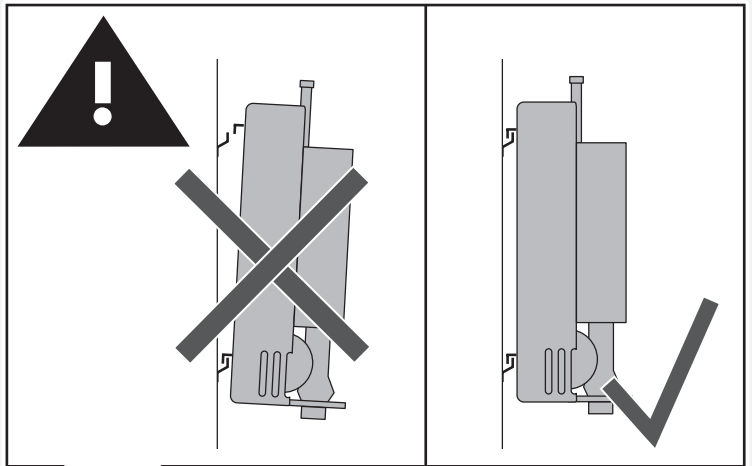
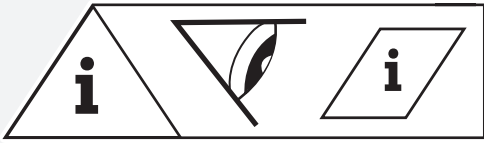
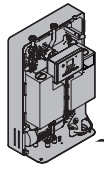

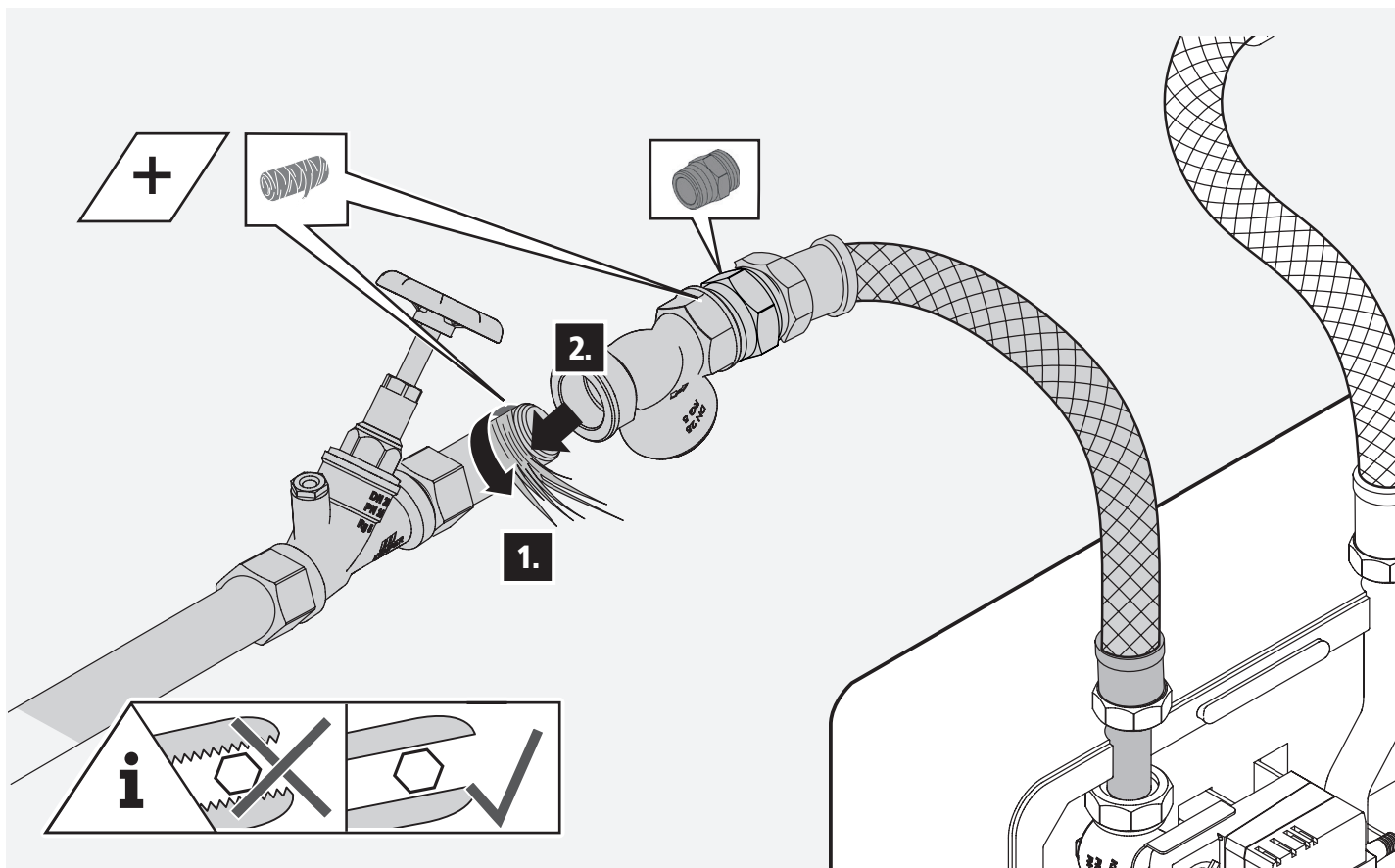
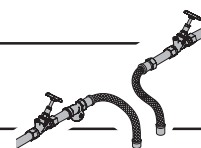
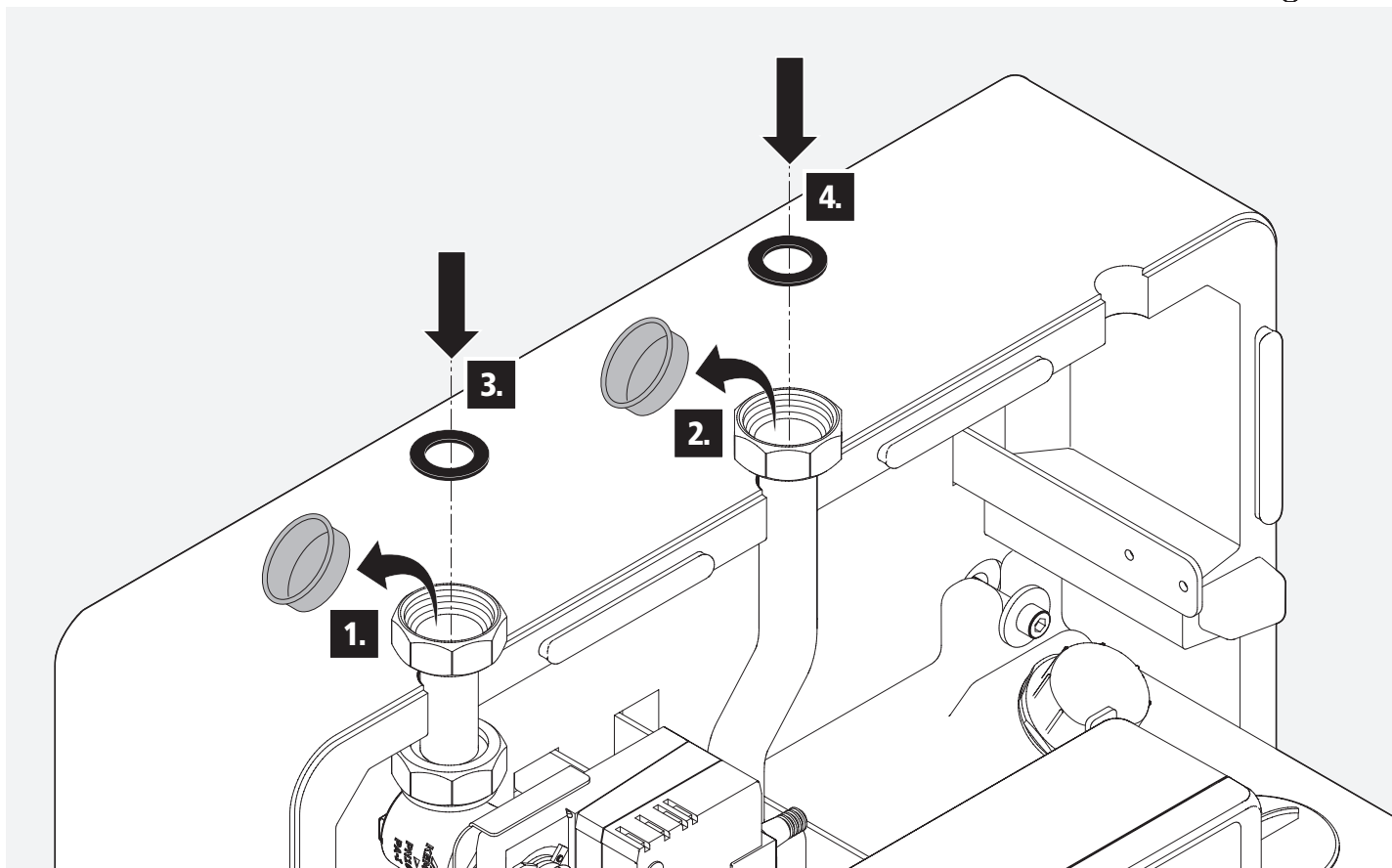
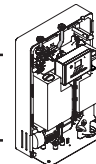

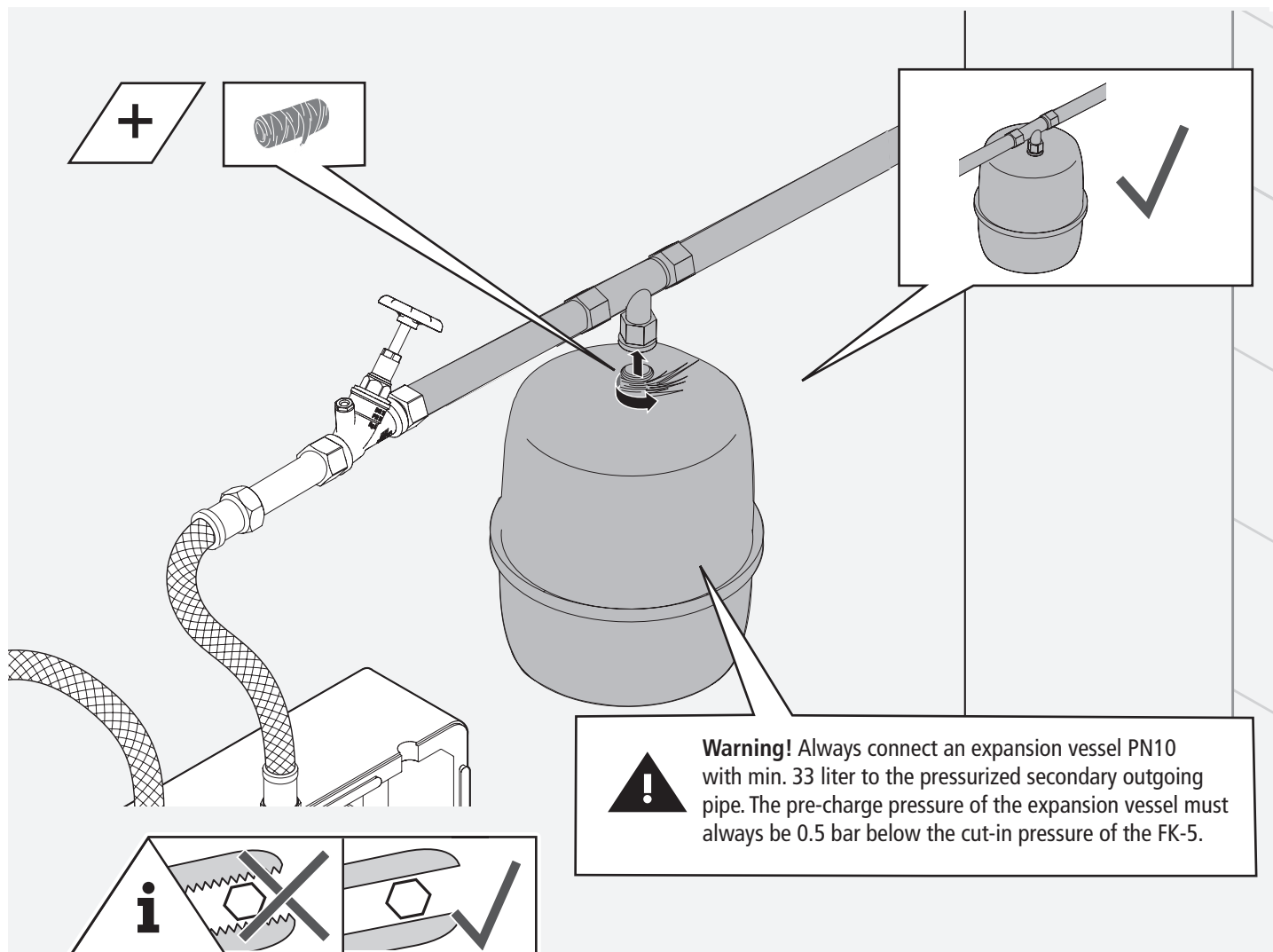
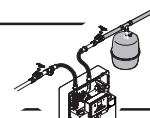

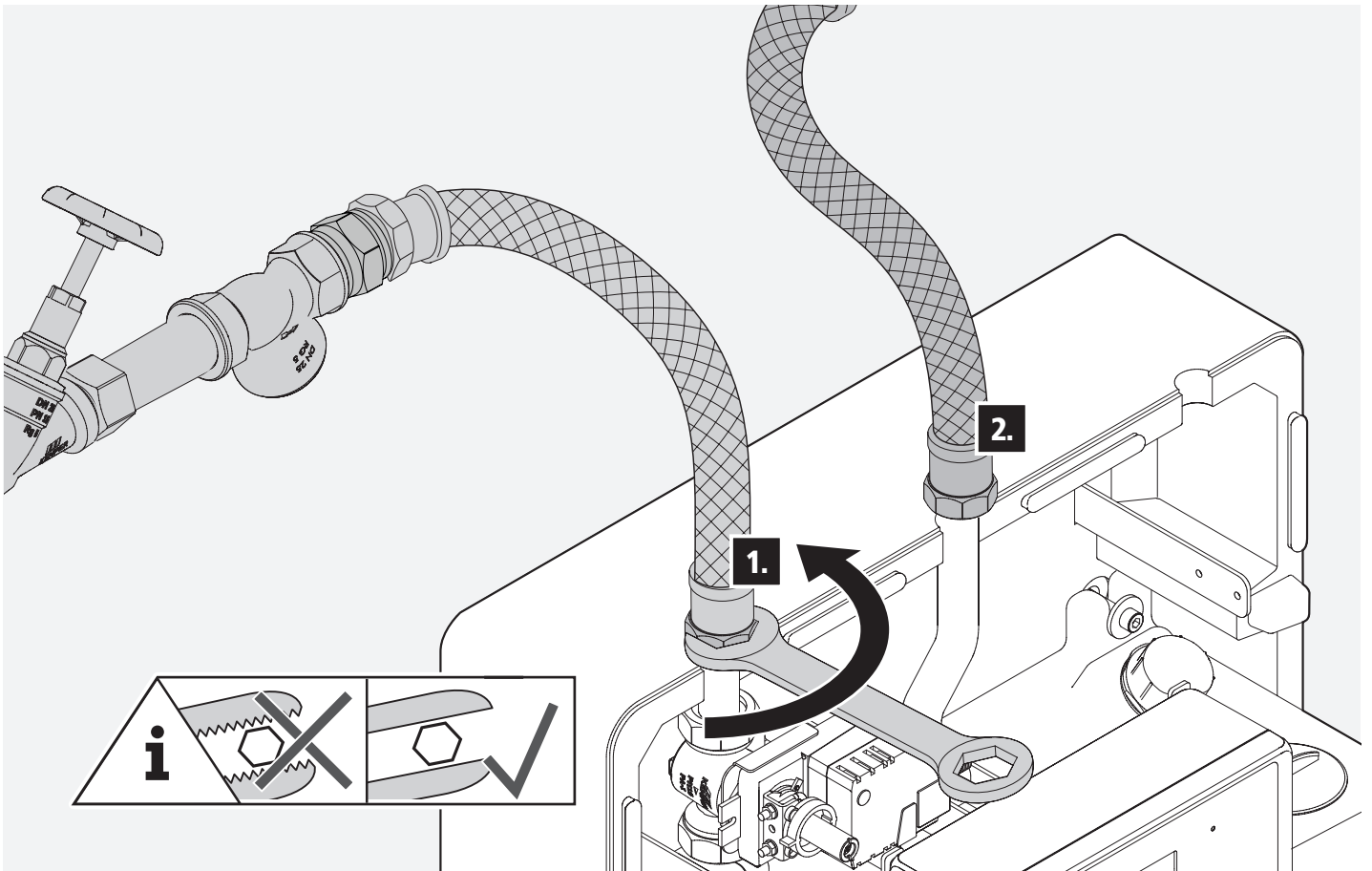
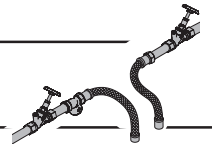

14

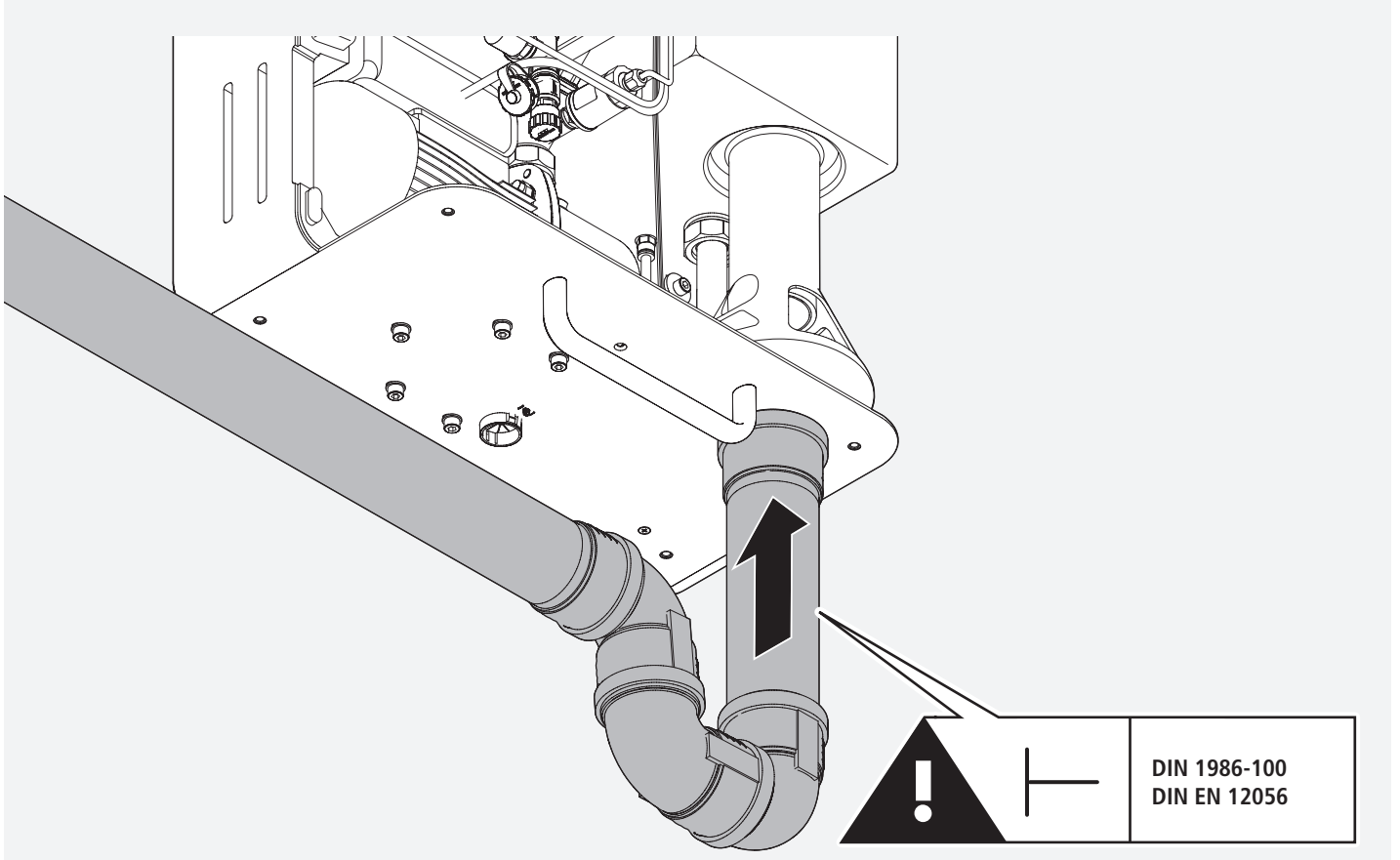
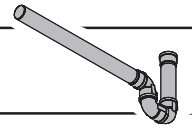

15

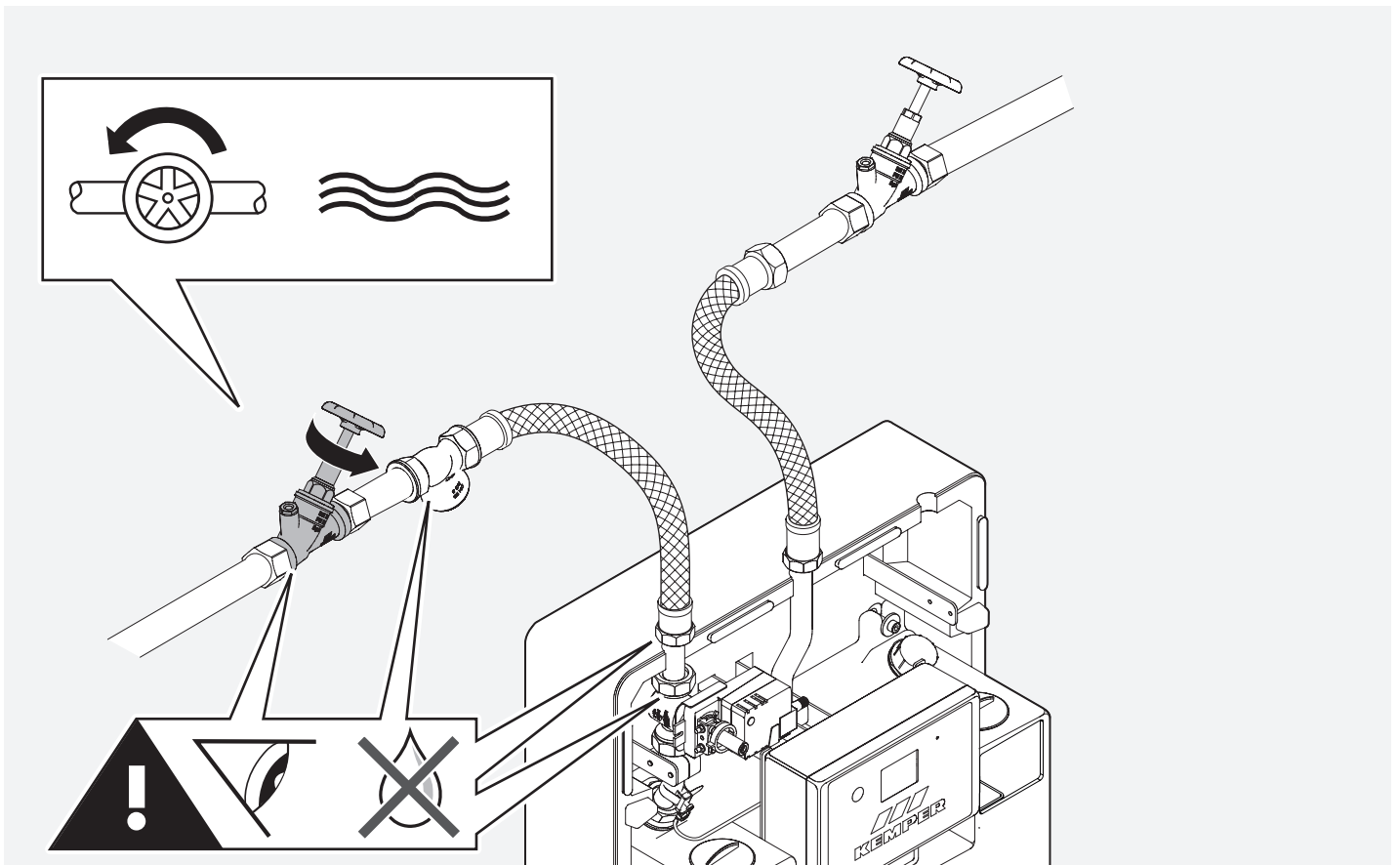
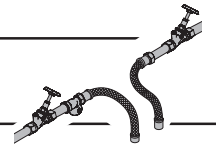

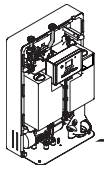

16

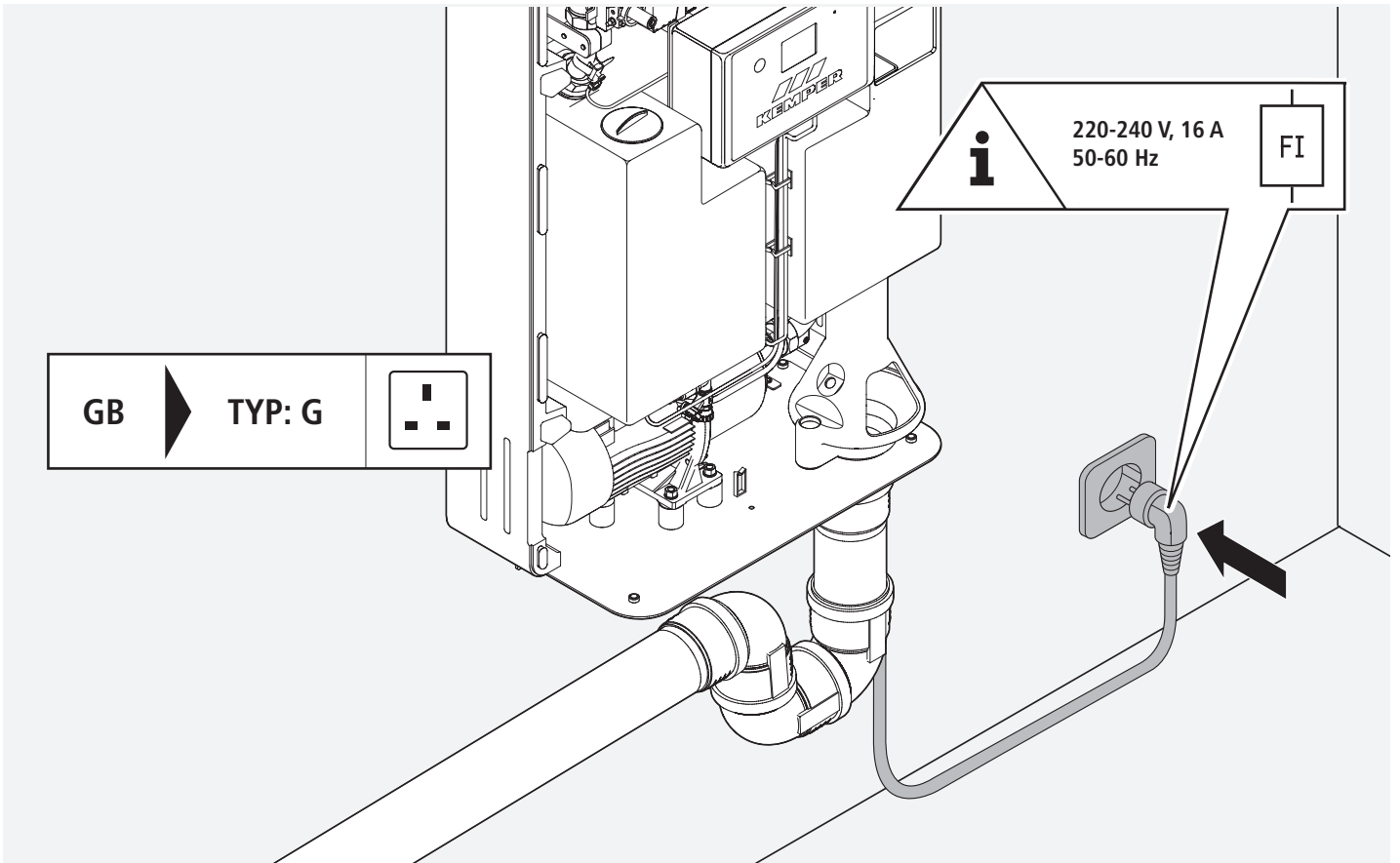

17

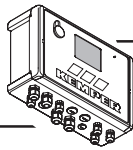

18

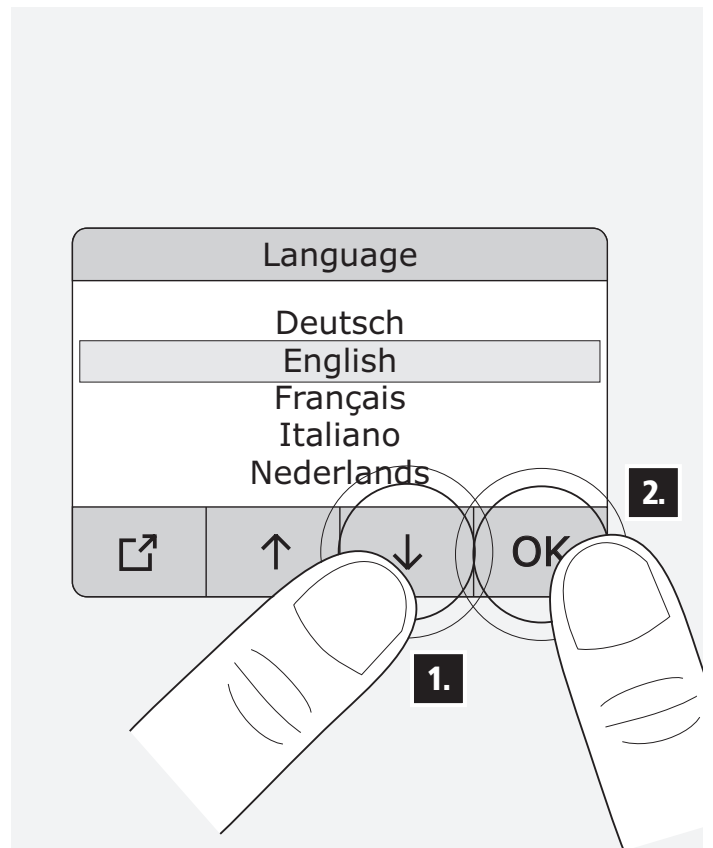
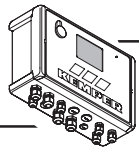

19

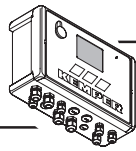

Commissioning

1. Language	English
2. Date	25.04.2016
3. Time	11:54:21
4. Settings OK	

Navigation icons: ↶, ↑, ↓, OK

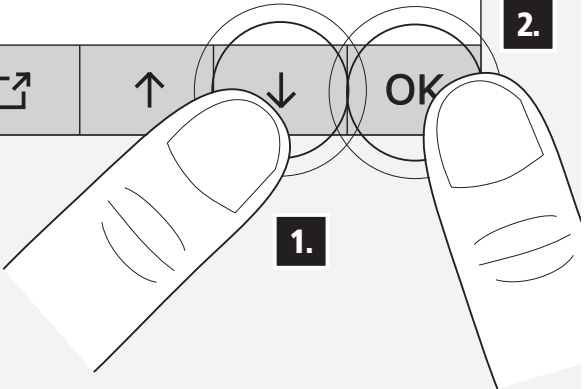

20

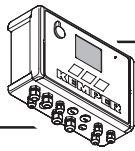

Date

dd.mm.yyyy 25.04.2016

1	2	3	0
4	5	6	
7	8	9	
↶	←	→	OK

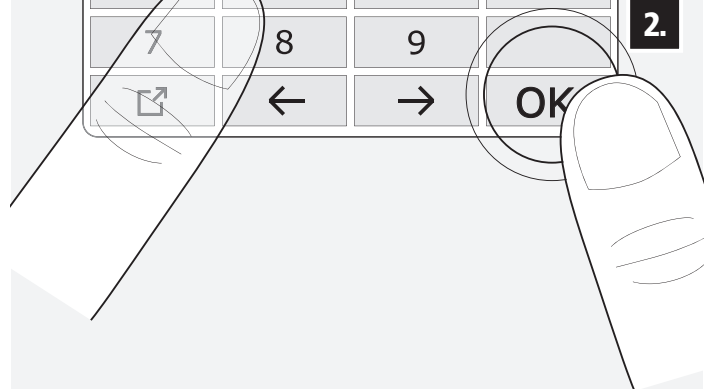

21

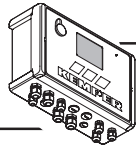

Commissioning

1. Language	English
2. Date	25.04.2016
3. Time	11:54:21
4. Settings OK	

Navigation icons: ↶, ↑, ↓, OK

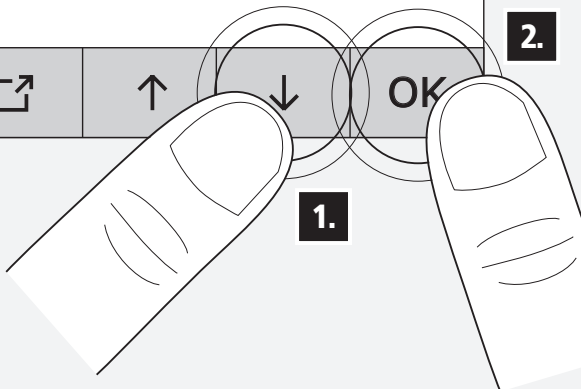

22

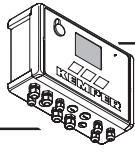

Time

hh.mm.ss 11:54:21

1	2	3	0
4	5	6	
7	8	9	
↶	←	→	OK

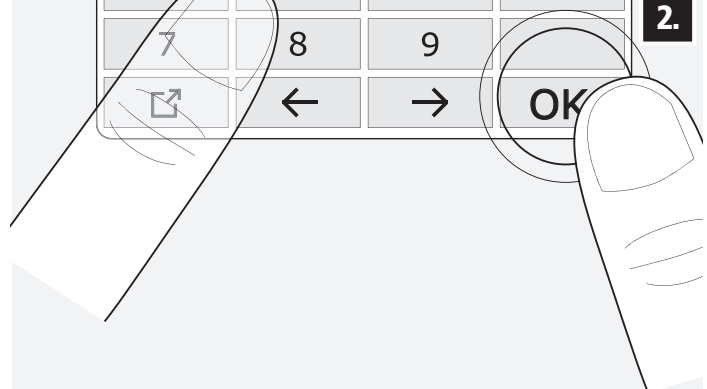

23

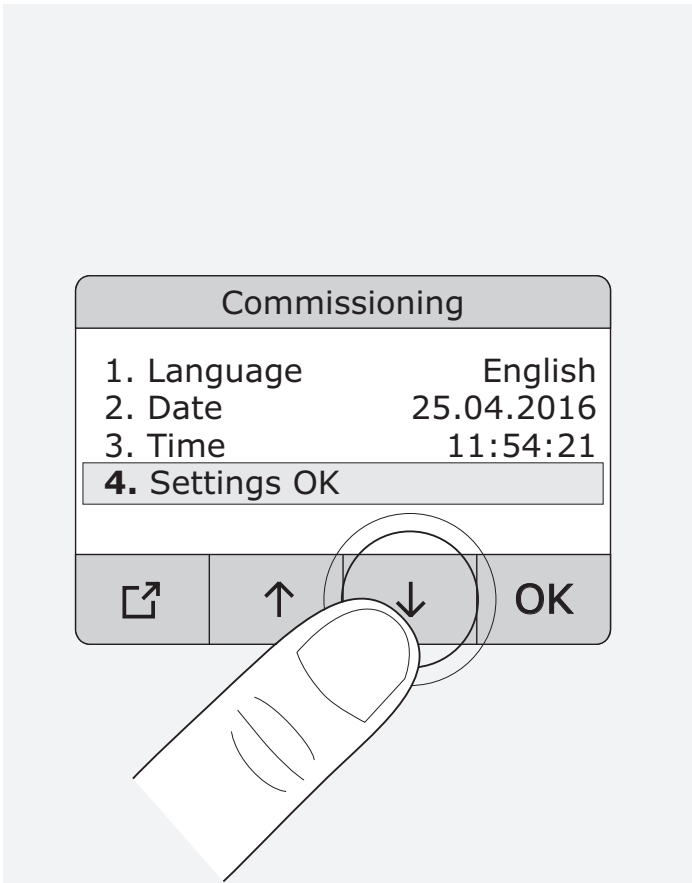

24

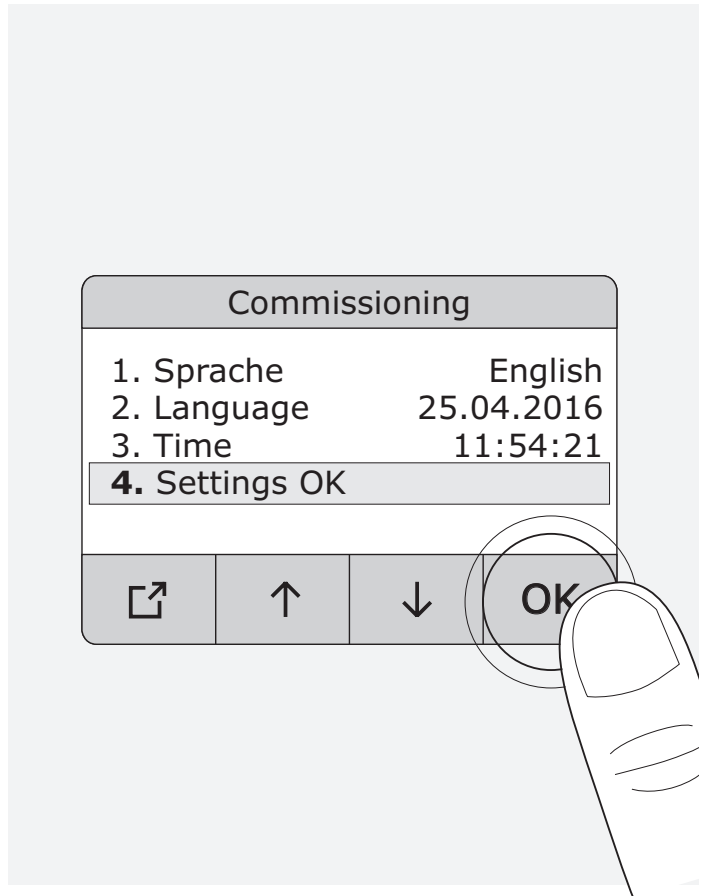

25

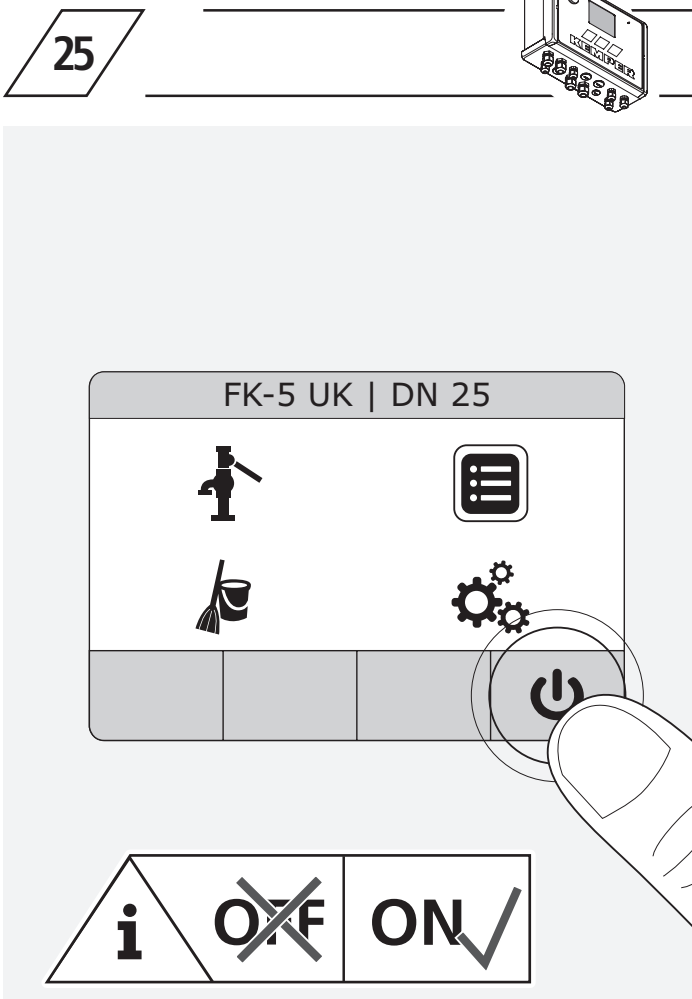

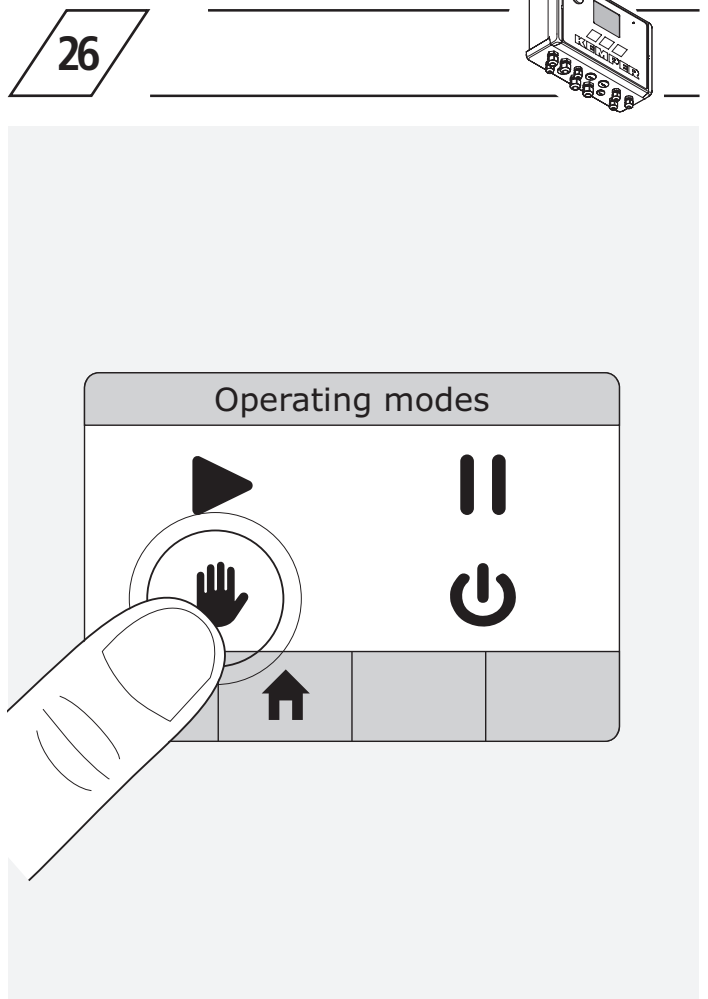

26

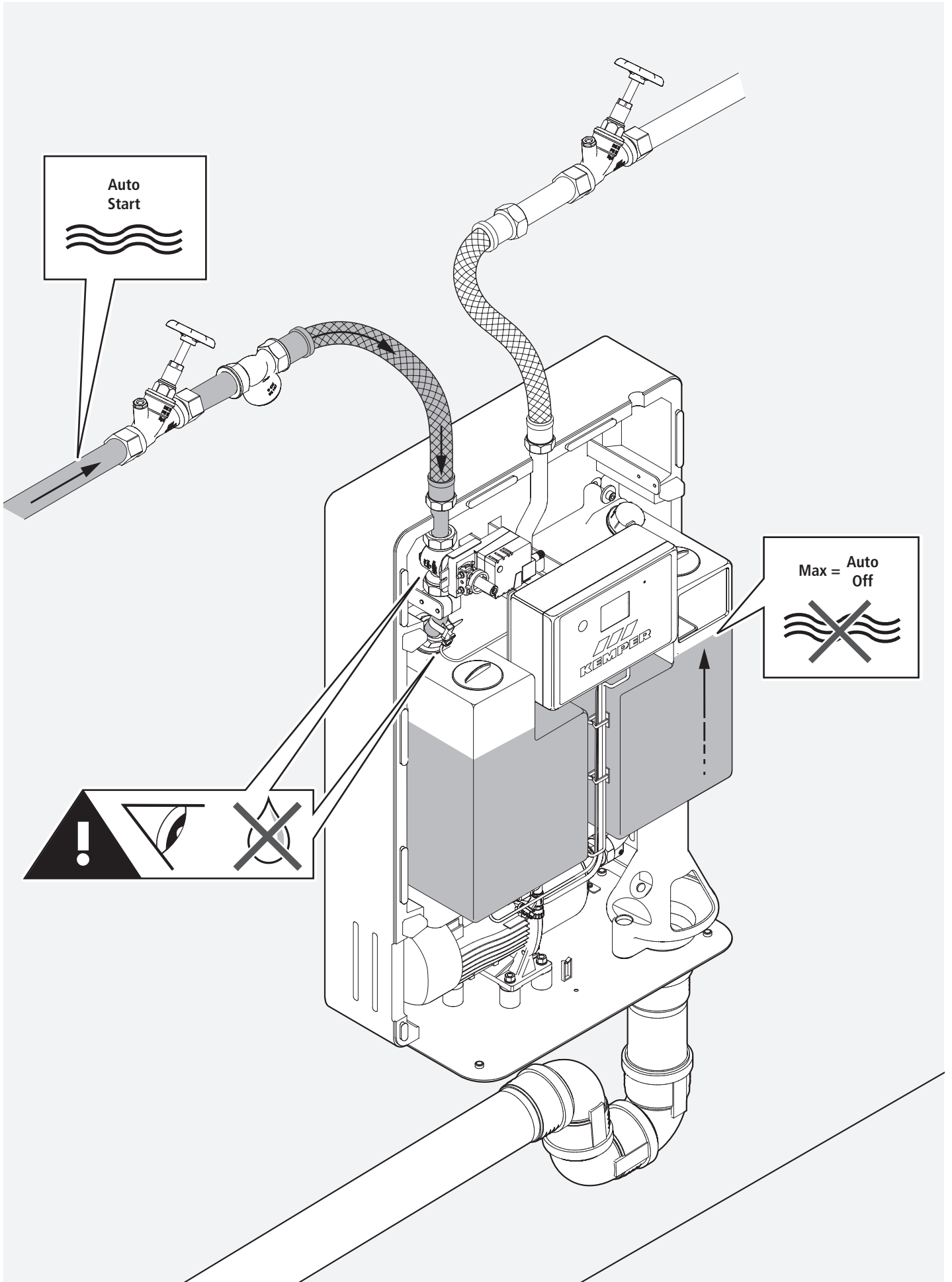
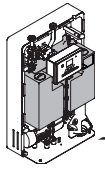

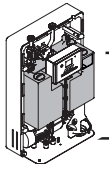

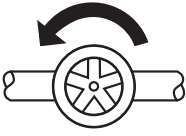

1.  **Auto Start** 

2.   

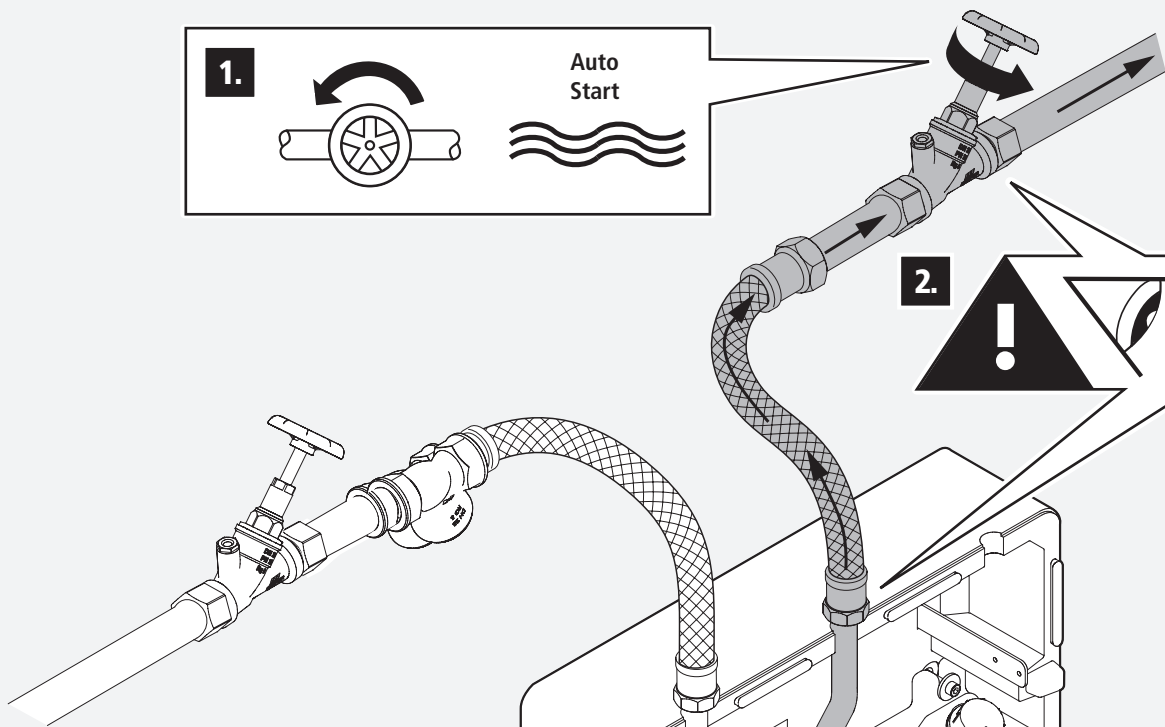

2.   

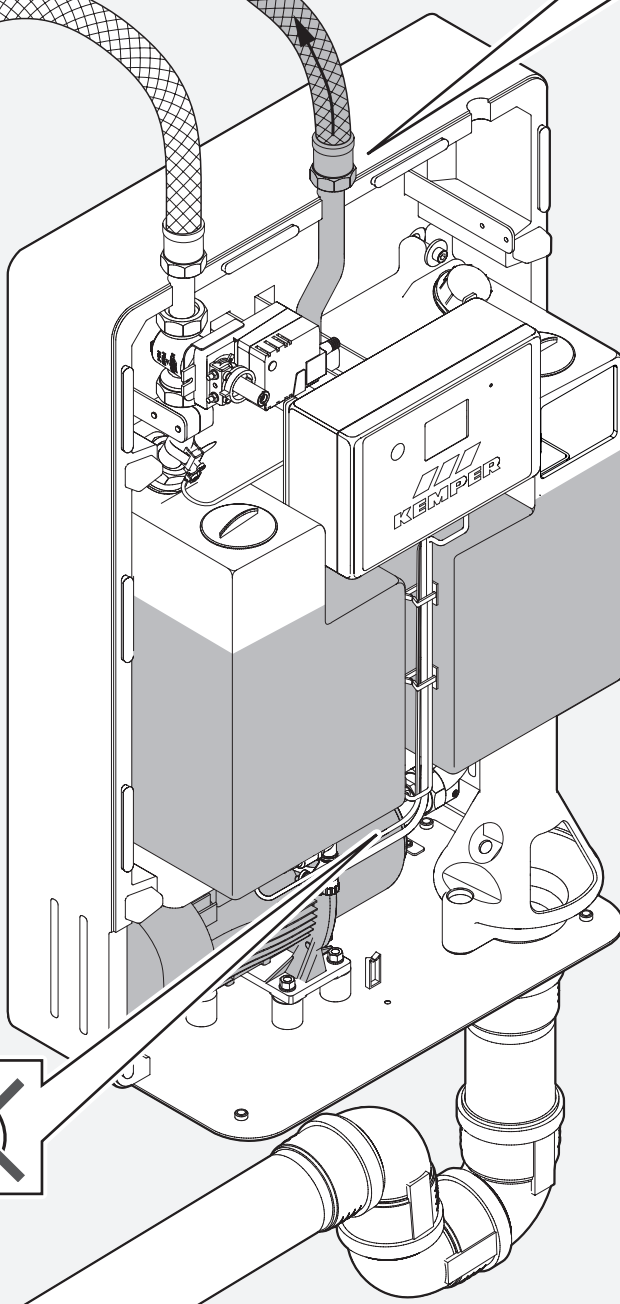

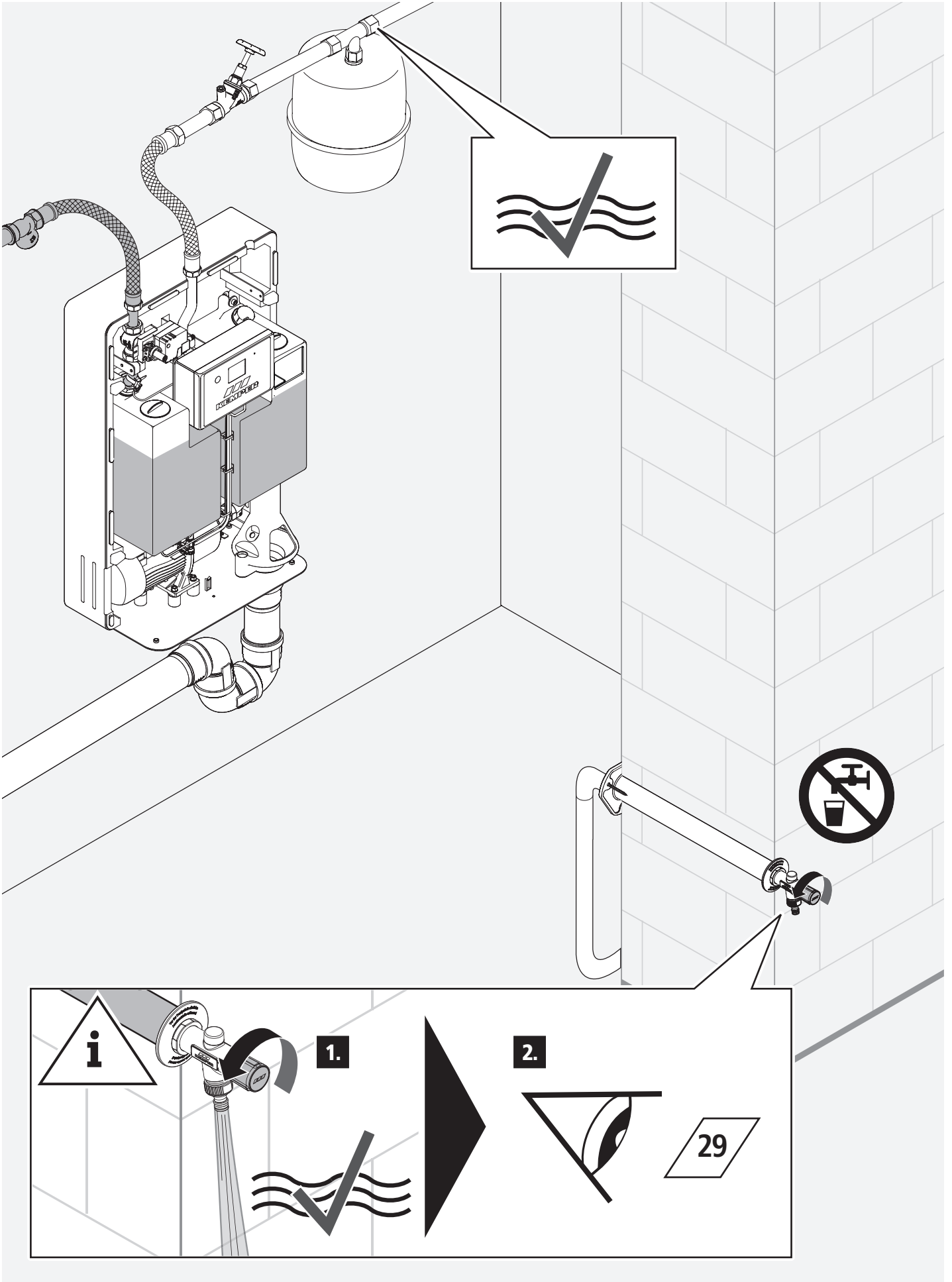
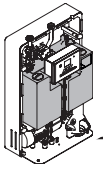

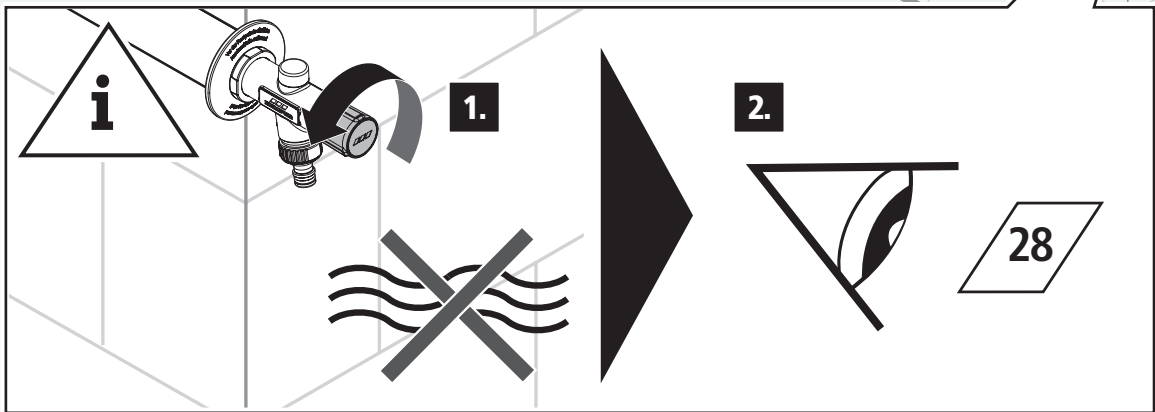
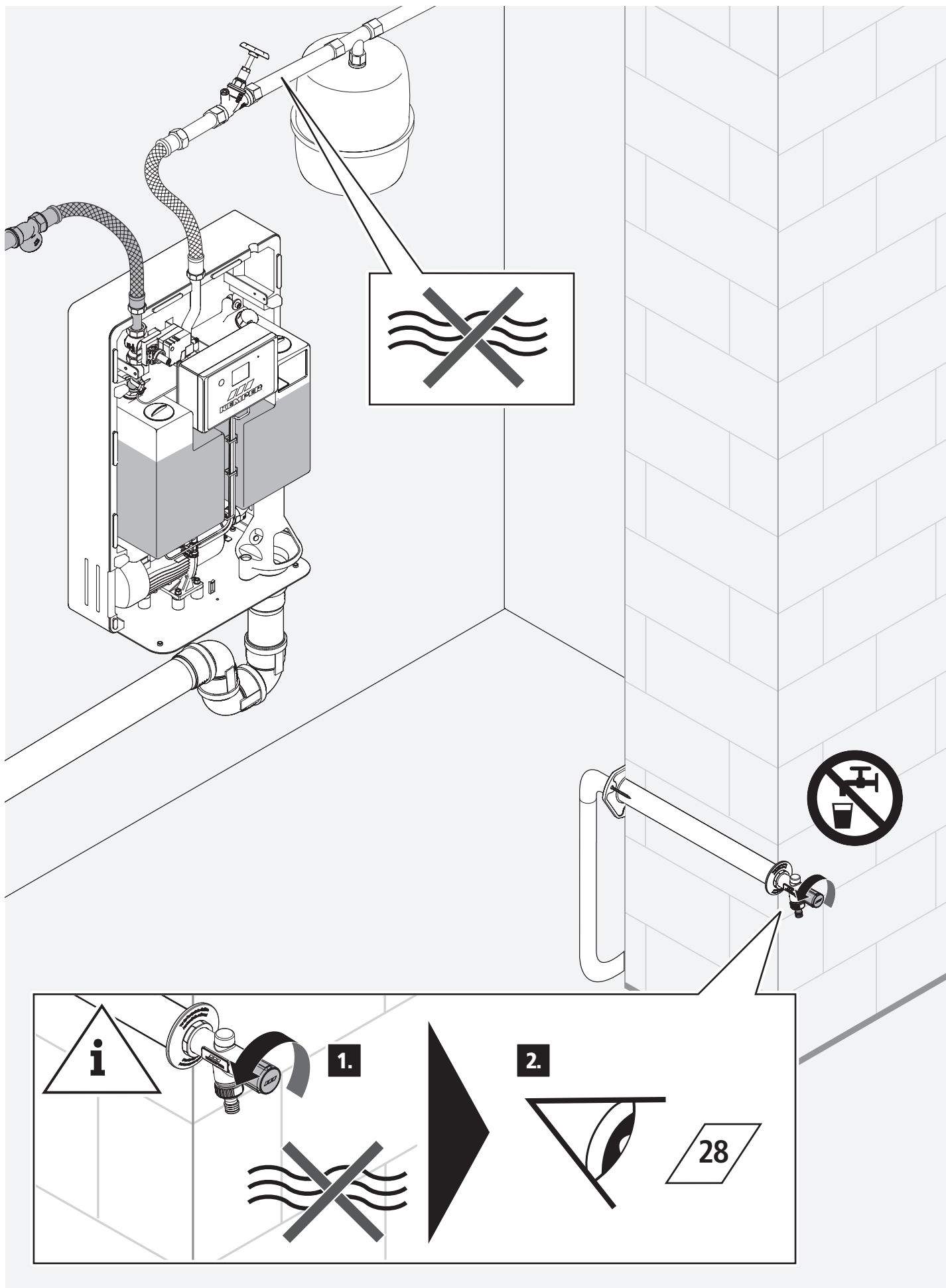
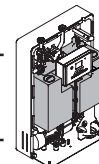

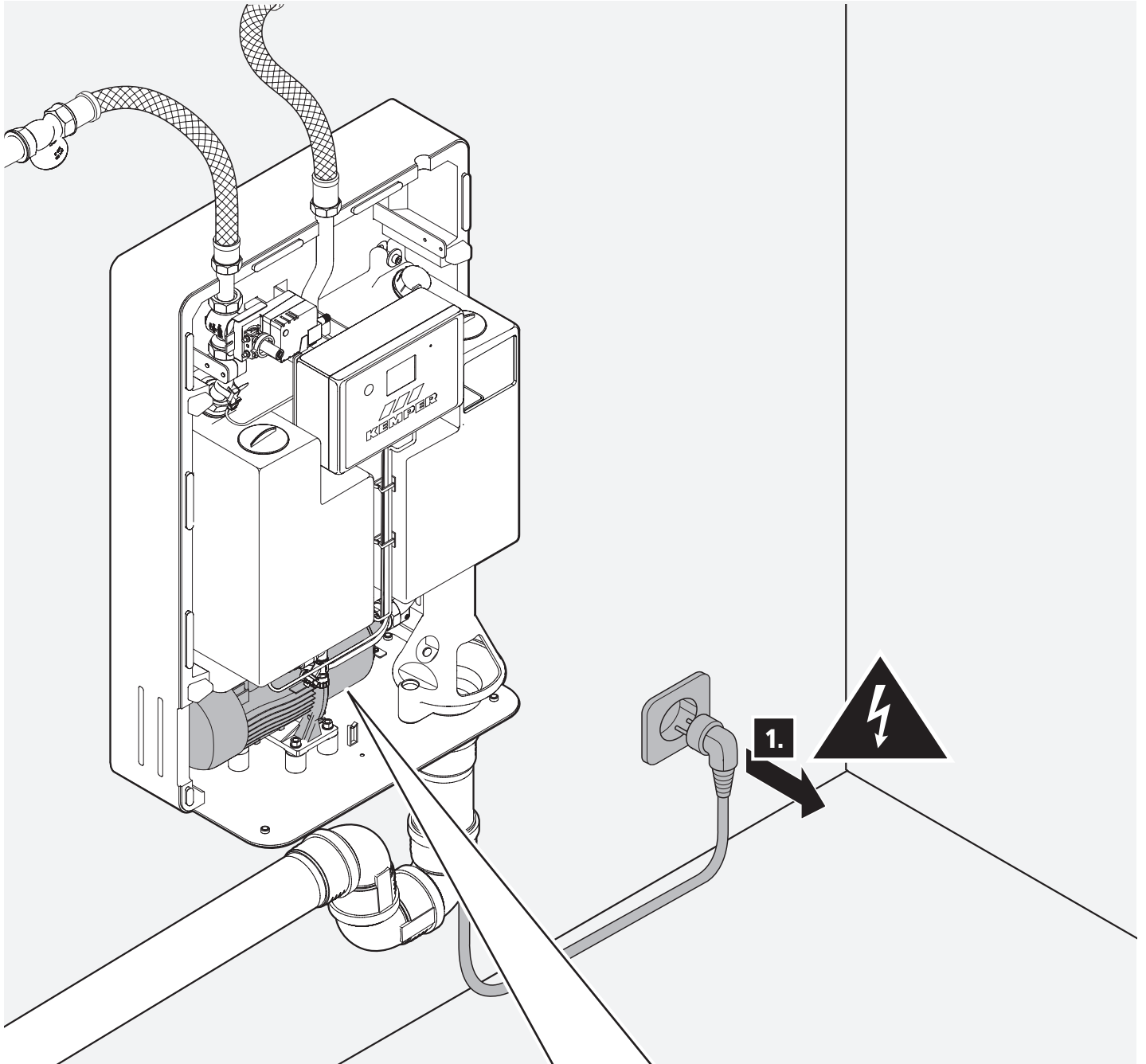
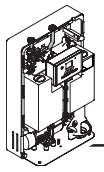

1.



2.

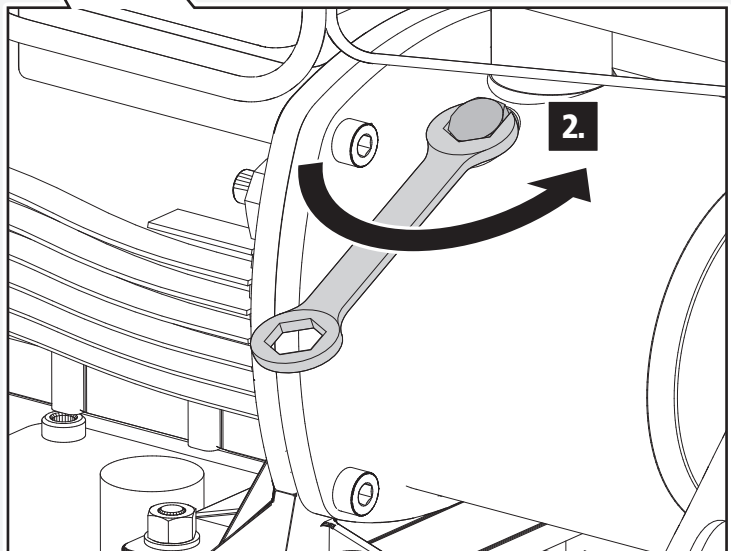

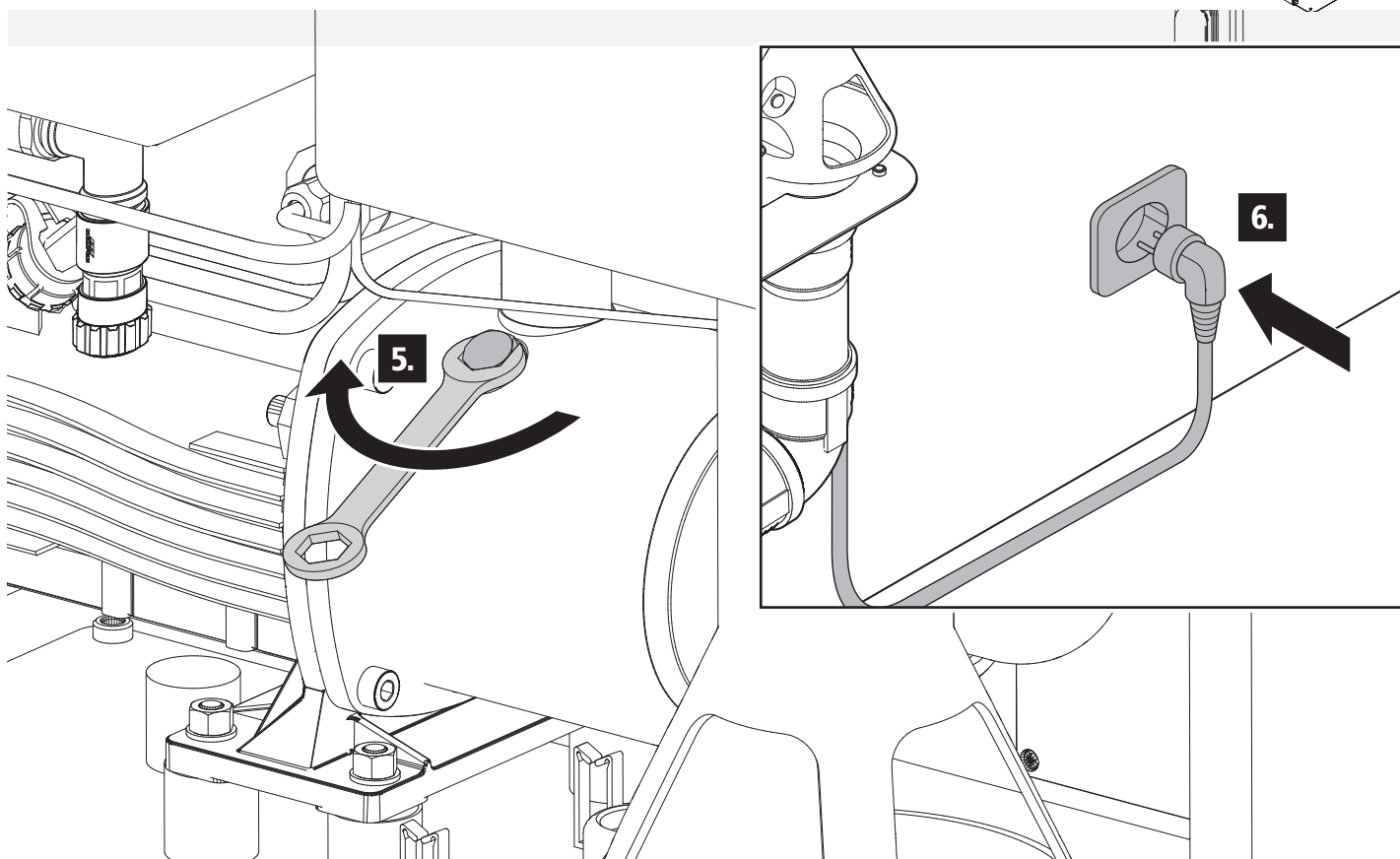
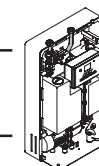
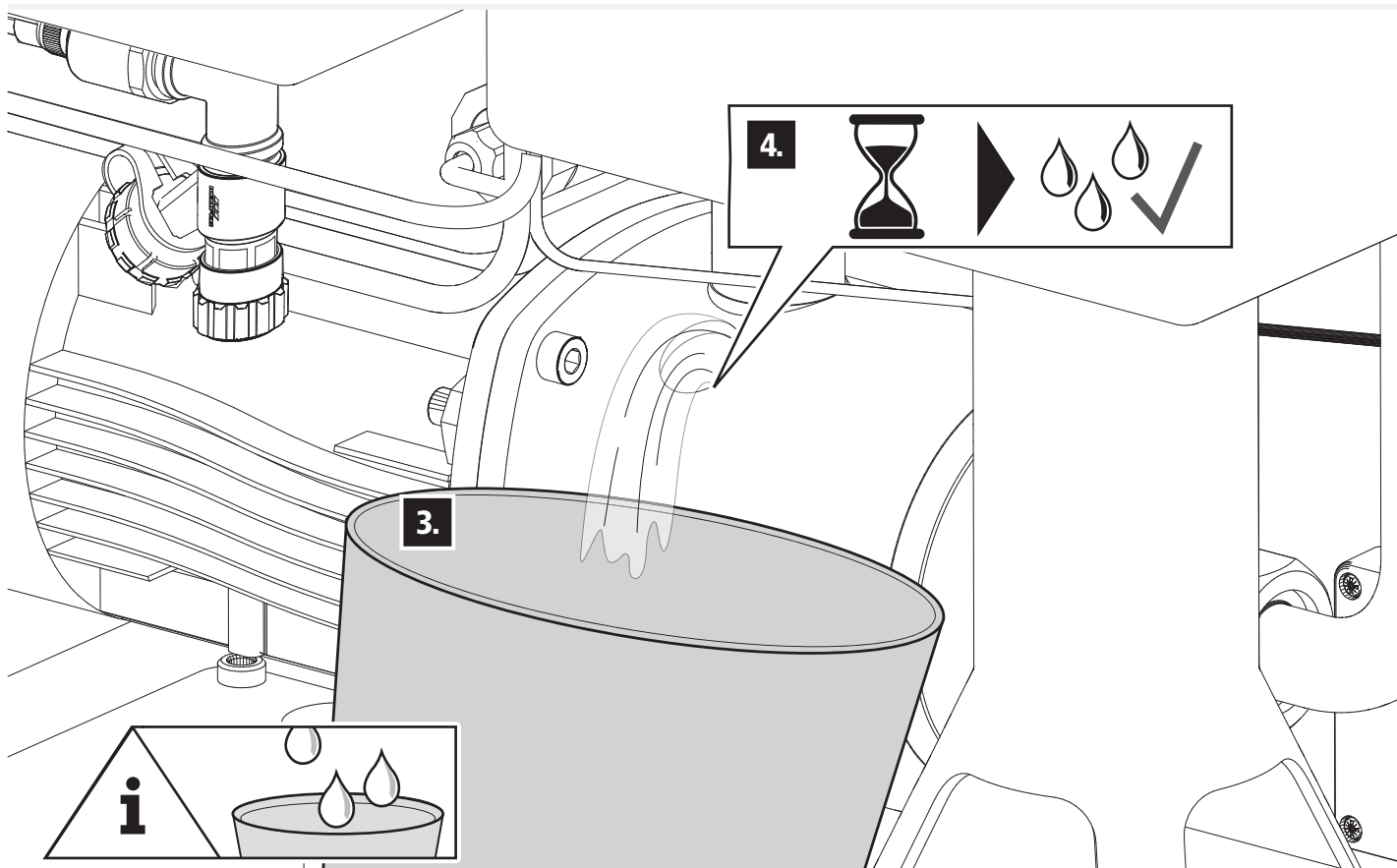
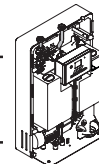

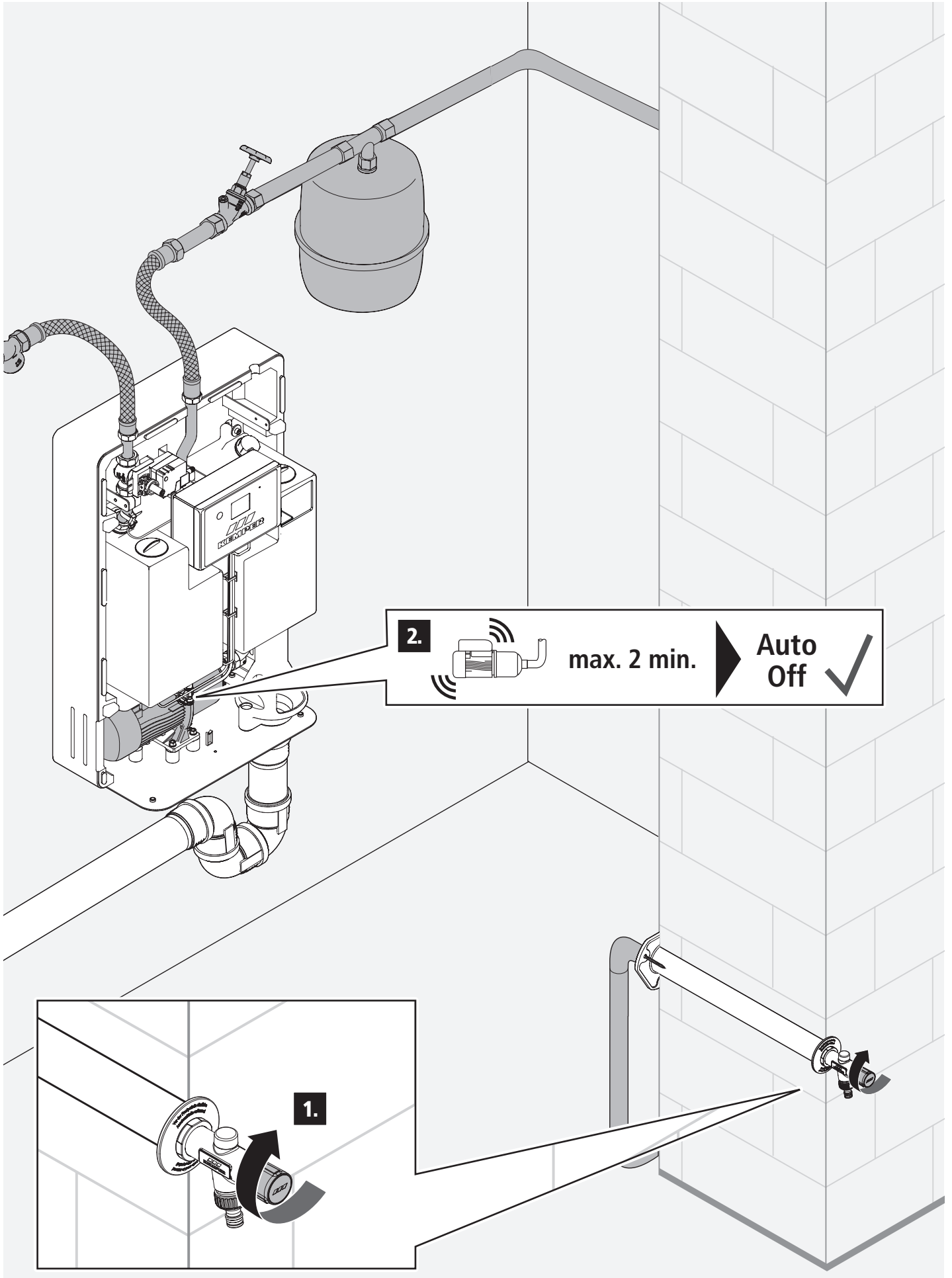
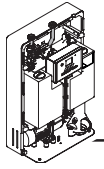

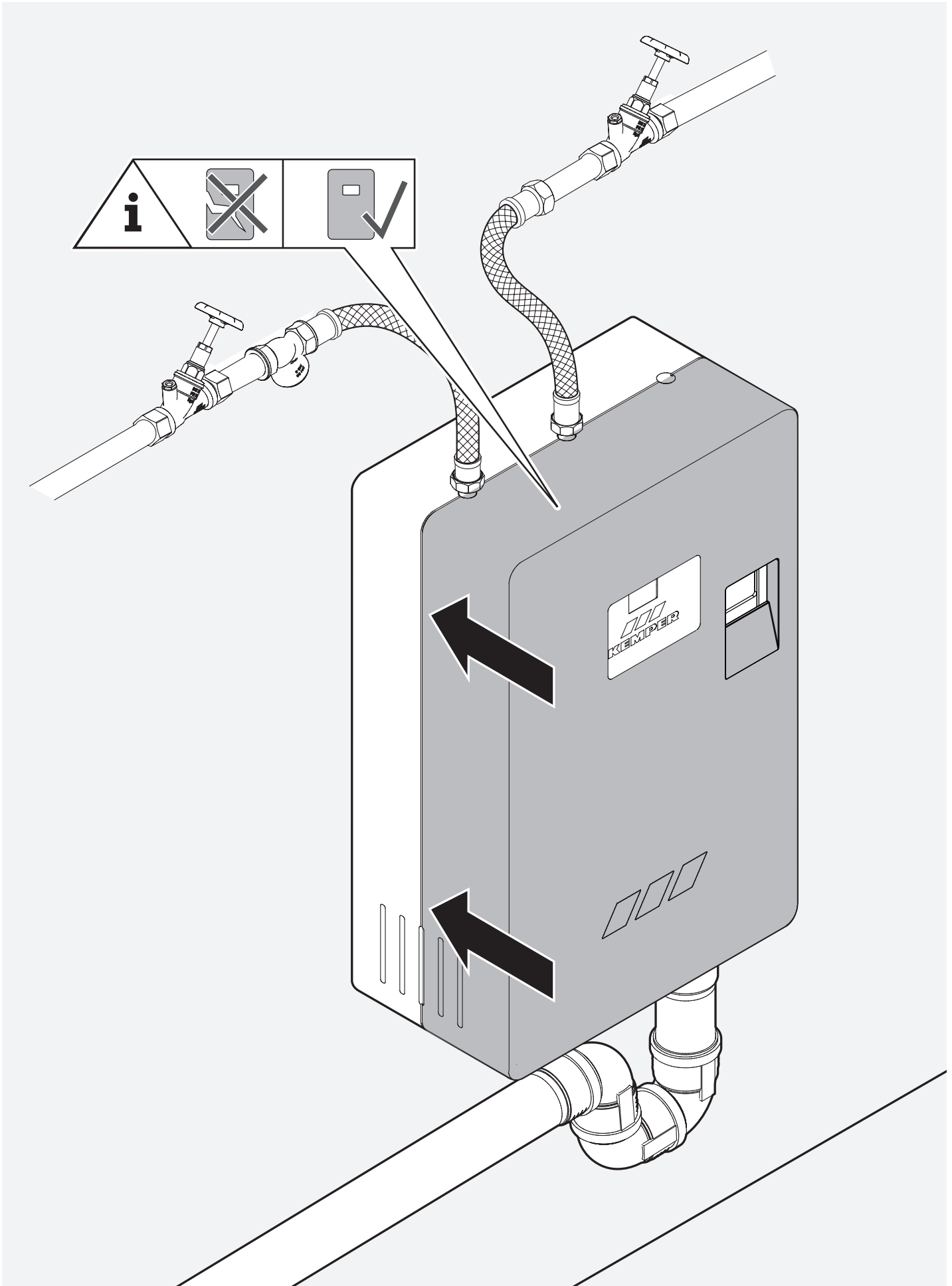
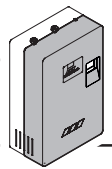

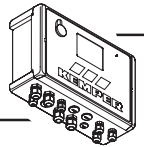
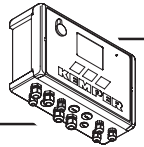
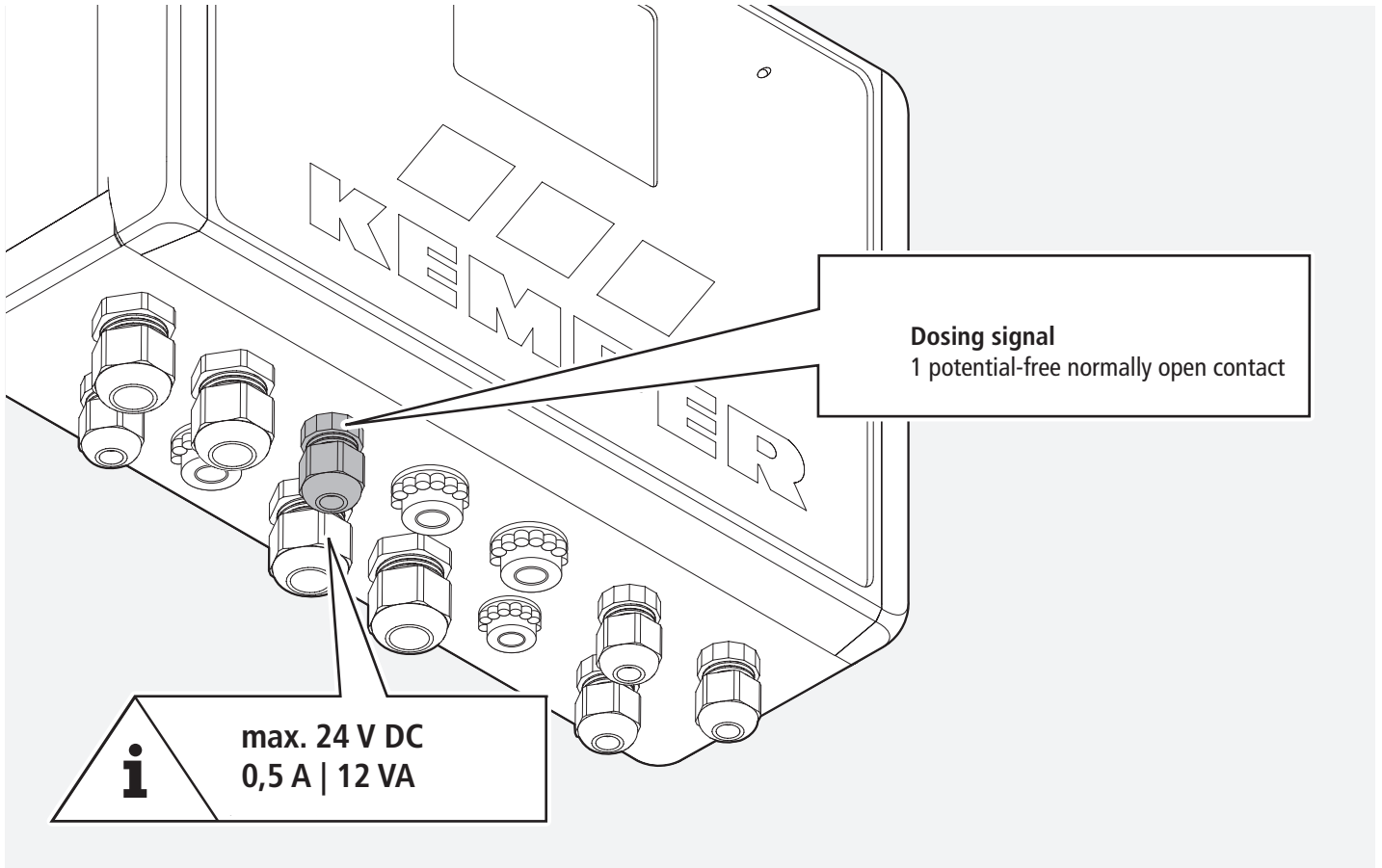
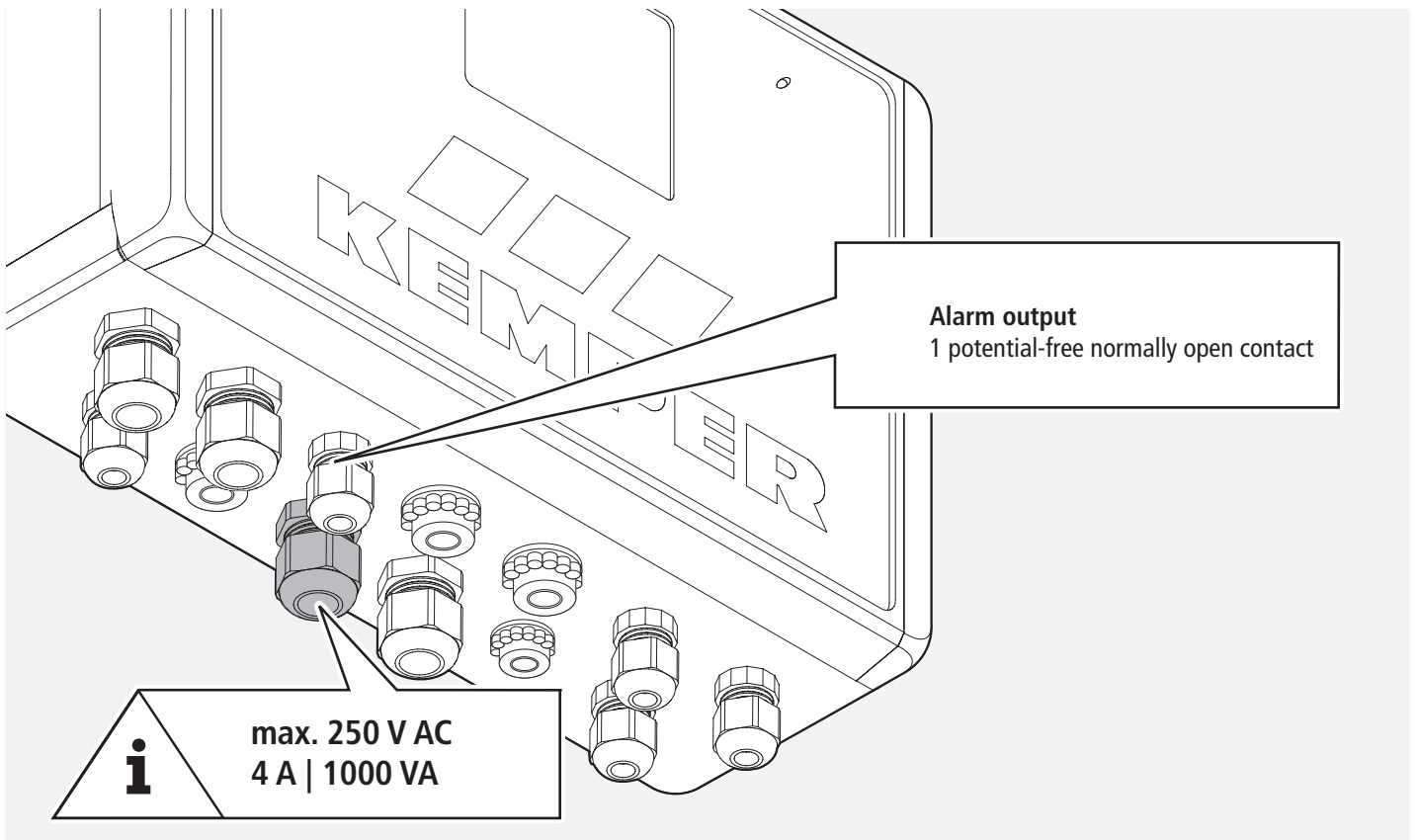
**i****A****i****B**

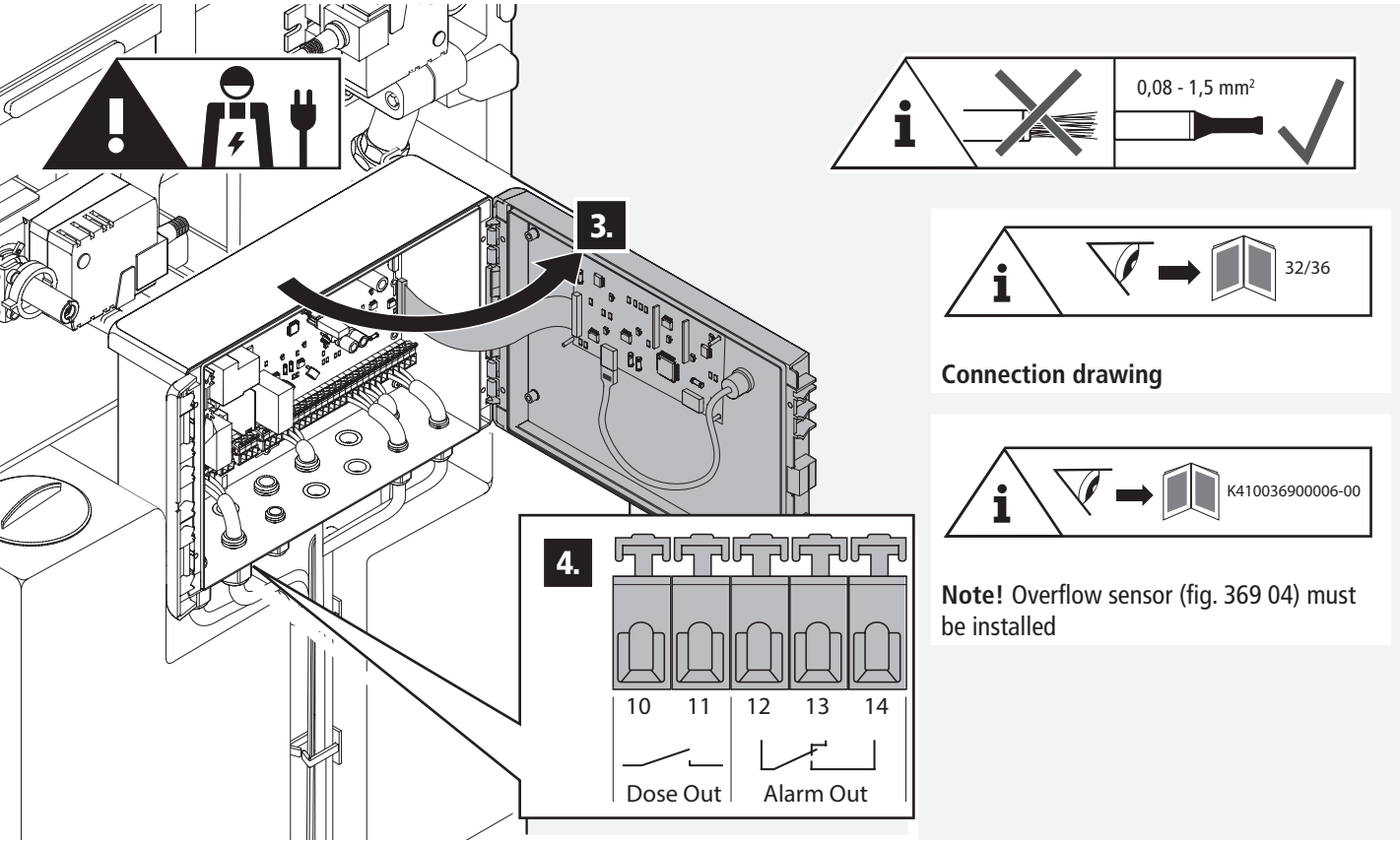
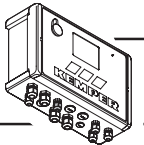
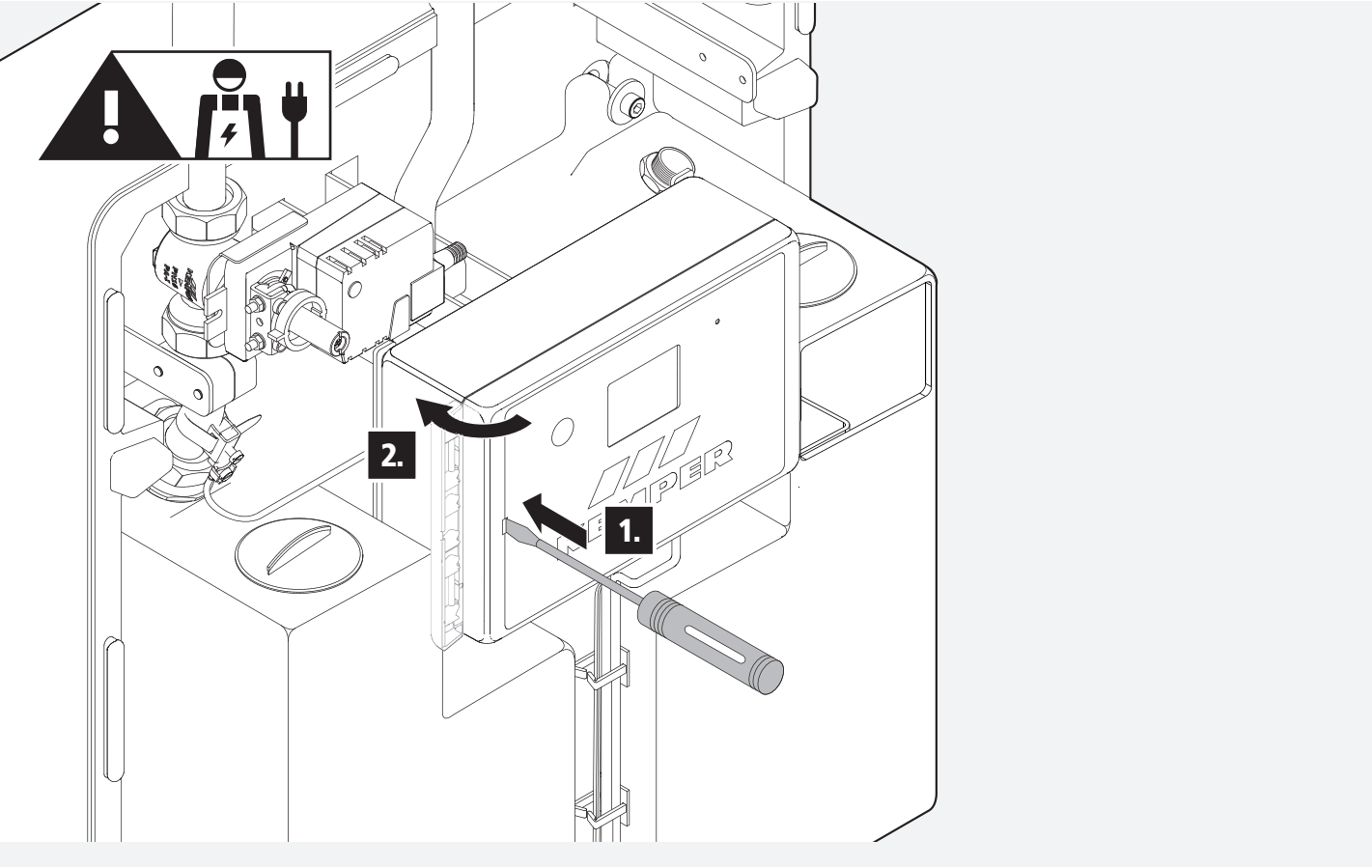
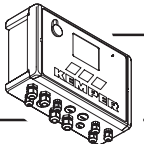

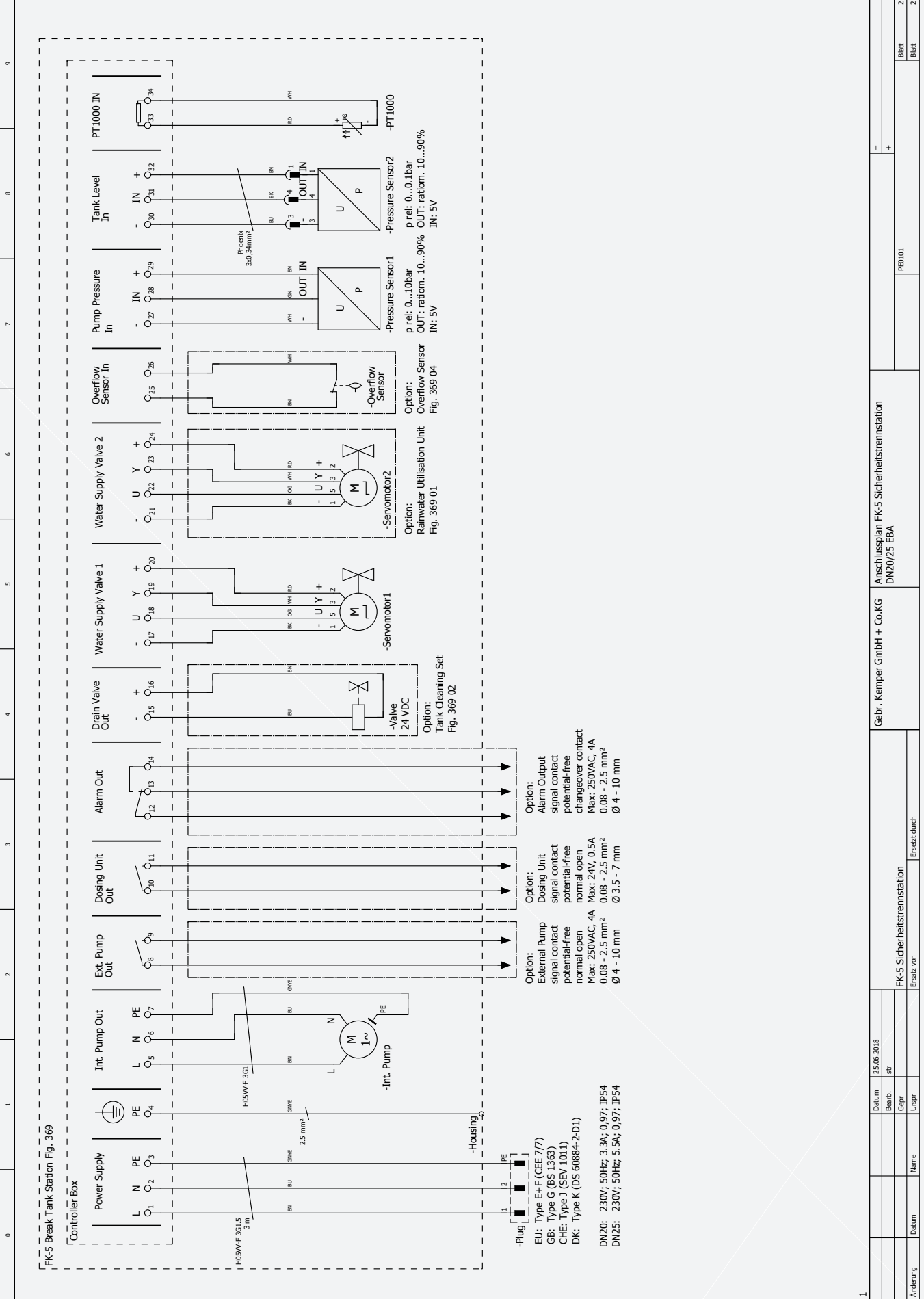

1		2		3		4		5		6		7		8		9	
Anschlussplan FK-5 Sicherheitstrennstation DN20/25 EBA																	
Gedr. Kemper GmbH + Co.KG																	
Ersatz durch																	
FK-5 Sicherheitstrennstation																	
Ersatz von																	
25.06.2018																	
str																	
Gepr.																	
Unspr.																	
Name																	
Datum																	
Blatt																	
2																	



DIN EN 806-5

Maintenance

Inspection and maintenance

Every 6 months, maintenance must be carried out in accordance with DIN EN 806-5.

The installed rechargeable battery must be replaced at three-year intervals. Controller warnings in this regard must be treated with priority.

Every 6 months, an inspection must be carried out.

National or regional regulations must be observed with priority.



Gebr. Kemper GmbH + Co. KG
Harkortstraße 5
D-57462 Olpe



Service-Hotline +49 2761 891-800
www.kemper-group.com
anwendungstechnik@kemper-group.com

K410036900028-00 / 11.2023