

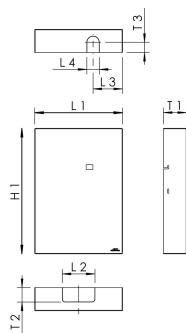

Product Features

- for covering KHS HS2® hygienic flushing box when surface mounted
- DC 01 fine sheet steel, powder-coated RAL 7035
- Incl. fixing material



Part no.	H1 (mm)	L1 (mm)	L2 (mm)	L3 (mm)	L4 (mm)	T1 (mm)	T2 (mm)	T3 (mm)	kg
6890700100	650.5	455.5	170	152.75	65	120	75	53	8.4