

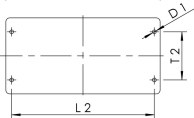

### Product Features

- to avoid stagnation acc. to standards and guidelines
- with detachable visual and / or acoustic error signal
- with potential free contact for error transmission to BMS
- with manual override button on control box
- for wall installation
- max. 16 programmable events
- display with background light

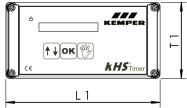

### Technical data

- min. ambient temperature 0 °C
- max. ambient temperature 50 °C
- protection class IP54
- power supply 230 V AC
- switching capacity 230 V, 2 A
- floating alarm relay, max. 230 V, 2 A
- own consumption 3 W

Part no.	D1 (mm)	H1 (mm)	H2 (mm)	L1 (mm)	L2 (mm)	T1 (mm)	T2 (mm)	kg
6860201200	4	58	44.5	160	148	79	50	0.47

### Accessories

- KHS quarter turn stop valve, with 230 V actuator, figure 686 04
- KHS quarter turn stop valve PLUS, 230 V spring return actuator, figure 686 05
- KHS free drain with overflow sensor, figure 688 00
- KHS Flush Point, 230 V, figure 684 04