

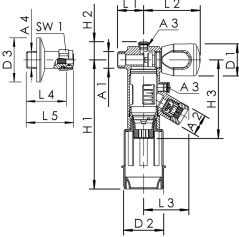

**Product Features**

- for normative refilling of apartment heating installations
- to protect drinking water against backflow of fluids up to and including category 4 according DIN EN 1717 / DIN 1988-100
- suitable for connection to the elbow wallplates
- with union adapter and collar for installation in cramped confines
- made of brass, nickel plated
- EPDM-seat gasket
- with stainless steel mesh at inlet
- integrated differential pressure controlled and low-maintenance protection cartridge including CV
- with controllable reduced pressure zone
- test ports for connection of test valves for maintenance
- plastic drain connection according EN 1717
- free from dead spots
- for horizontal installation, drain valve down
- with isolating function for maintenance
- outlet with male thread acc. ISO 228 for hose connection
- maintenance requirements in accordance with DIN EN 806-5 must be complied with



**Standards and Approvals**

- DVGW approval
- VA approval
- plastic parts with KTW and W 270 approval
- according to accepted materials list from German environmental agency
- soundproofing certification according to DIN EN ISO 3822 Class 1
- EN 1717

**Technical data**

- pressure rating PN 10
- max. operating temperature 60 °C
- short-term peak temperature 65 °C

Part no.	DN	A1	A2	A3	A4	D1 (mm)	D2 (mm)	D3 (mm)	H1 (mm)	H2 (mm)	H3 (mm)	L1 (mm)	L2 (mm)	L3 (mm)
3680201500	10	G 1/2	G 3/4	G 1/8	R 1/2	40	50	55	161	22.7	98	32.5	70.5	56.3

Part no.	L4 (mm)	L5 (mm)	SW1 (mm)	nominal connection diameter, waste water (mm)	kg
3680201500	50	59	24	50	1.06

**Accessories**

- differential pressure measurement set, figure 360 99
- test valve with union adaptor for inspection of RPZ valves FK-4, figure 367 06
- test valve set for inspection of RPZ valves FK-4, figure 367 07

### Spare parts

- service set for RPZ backflow preventer outlet for appartments Type BA, figure 368 00 001
- union-adaptor for RPZ backflow preventer outlet for appartments Type BA, figure 368 03 001