

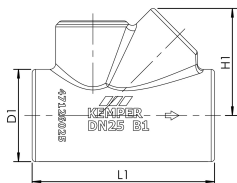

Product Features

- suitable for figure 150 6G and figure 151 06
- closed-cell foamed polyethylene, sound insulation
- simple installation using the insulation clips or diffusion-resistant lockable using standard adhesives



Standards and Approvals

- to meet the requirements of GEG 2023
- building material class B1 according to DIN 4102
- CE marking

Technical data

- min. operating temperature -40 °C
- max. operating temperature 90 °C

Part no.	DN	D1 (mm)	H1 (mm)	L1 (mm)	kg
4712601500	15	65	82	114	0.02
4712602000	20	70	86	126.5	0.02
4712602500	25	80	82	159	0.01
4712603200	32	90	90	170	0.01
4712604000	40	120	91	199	0.03
4712605000	50	140	96	228	0.09